

DETAIL G
SCALE 1 : 2

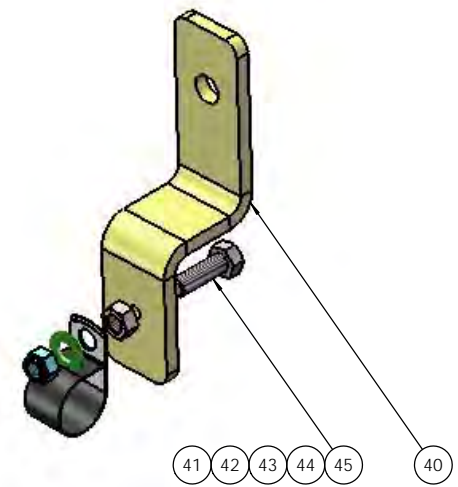

DETAIL F
SCALE 2 : 3

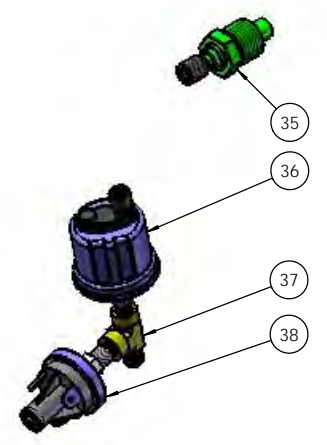

DETAIL E
SCALE 1 : 2

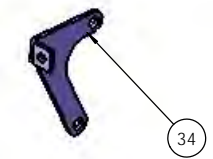

DETAIL D
SCALE 1 : 4

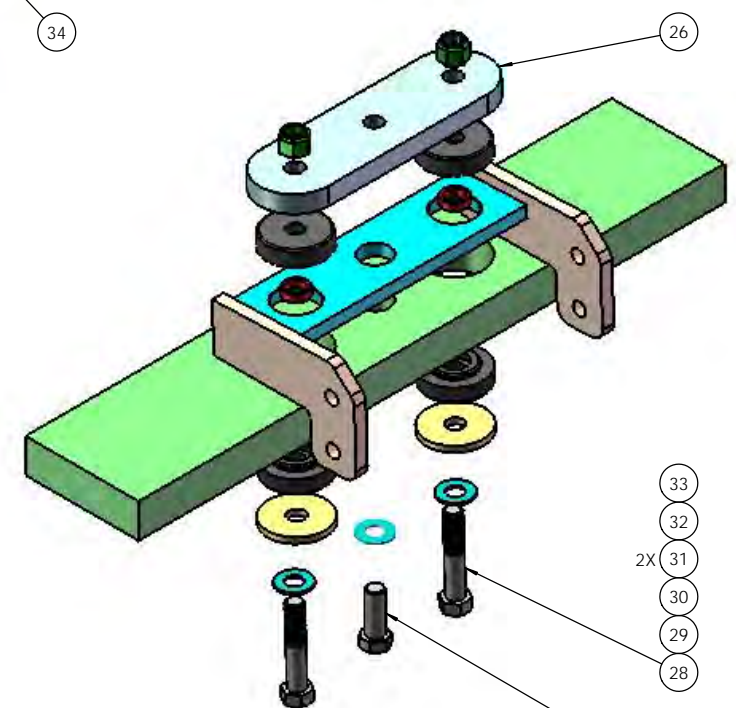

DETAIL C
SCALE 1 : 3

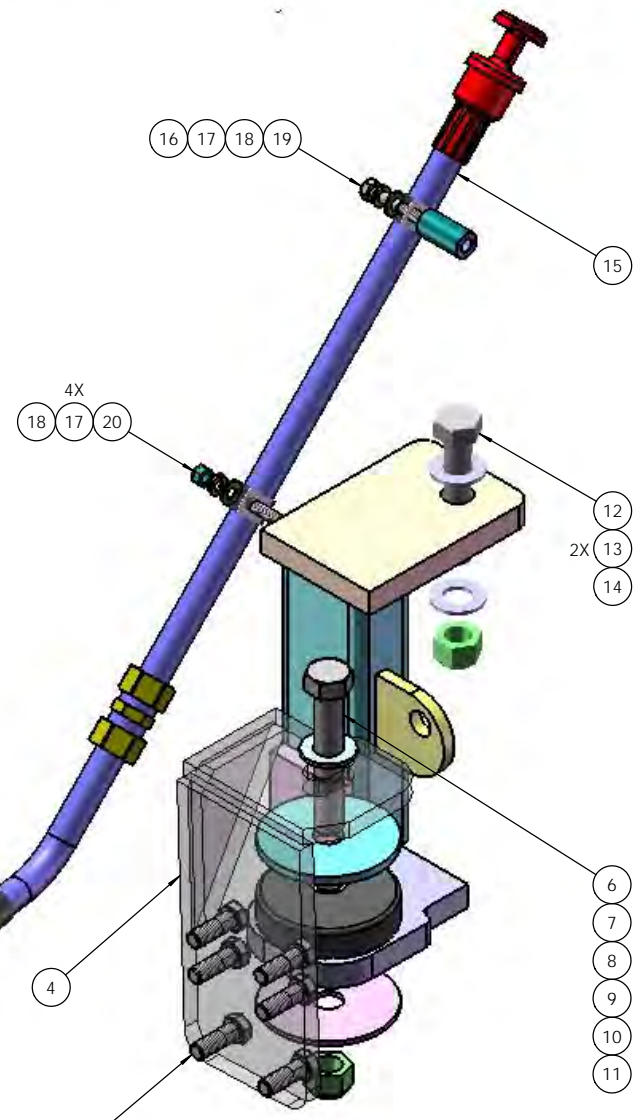
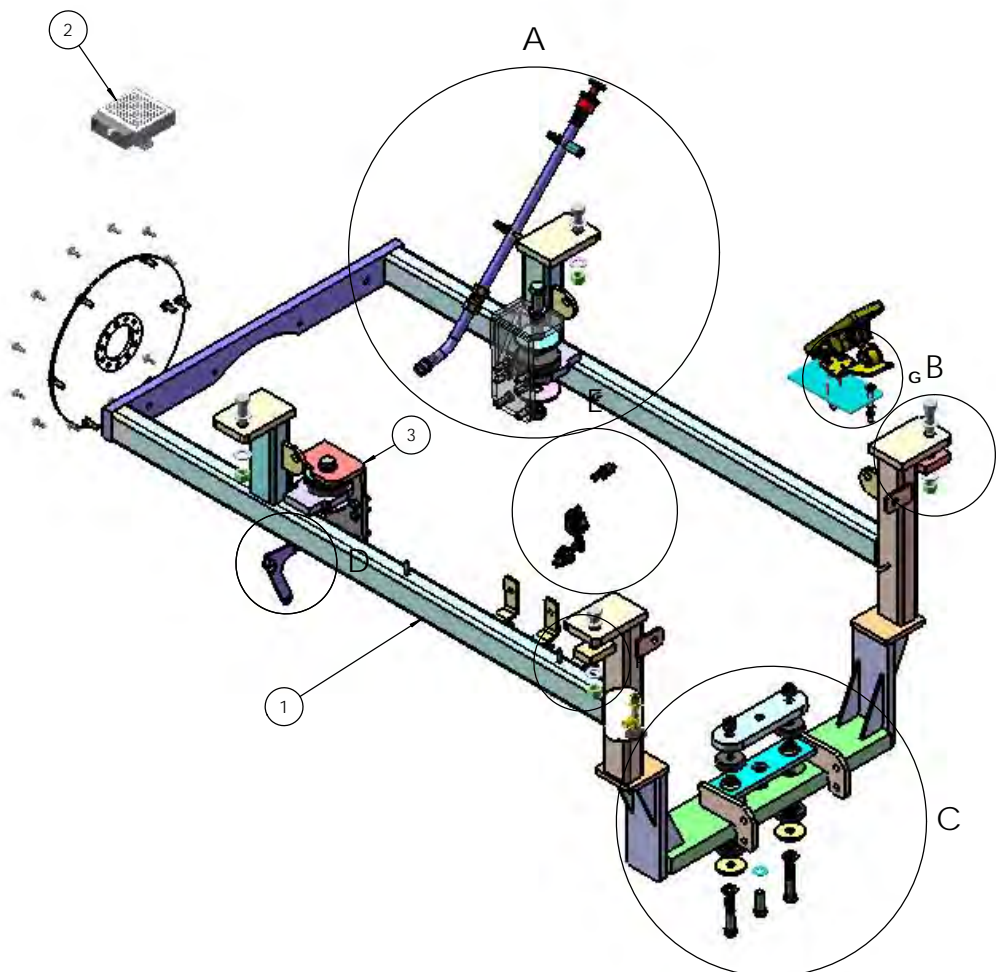

DETAIL A
SCALE 2 : 5

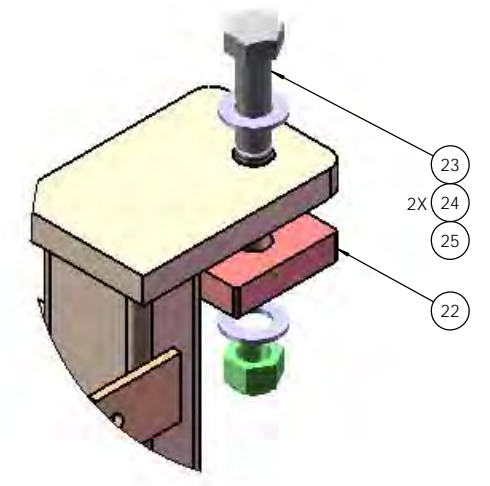

DETAIL B
SCALE 1 : 2

NOTE:
ENGINE & TRANSMISSION NOT SHOW FOR CLARITY

DIMENSIONS ARE IN INCHES TOLERANCES: DECIMAL XX ± 0.06 XXX ± 0.03 XXXX ± 0.005 ANGULAR ± 0.5° FRACTIONAL ± 1/32"		NAME SMB DATE 08/20/2014	TICO/TERMINAL SERVICE 44 CYPRESS RIDGE DR. RIDGELAND, SC 29936 (843) 717-2226
INTERPRET GEOMETRIC TOLERANCING PER: ASME Y14.5M-1994		APPROVED MPC 06/03/2016	
MATERIAL		TITLE: ENGINE & TRANSMISSION	
FINISH		SIZE D	DWG. NO. 72287-D1
THICKNESS		REV	
		SHEET 1 OF 1	

TICO PRO-SPOTTER				
S/N:		ASSEMBLY, ENGINE & TRANSMISSION		72287
ITEM	PART #	QTY/M	DESCRIPTION	
	60023	REF	GOVERNOR, AIR D-2	
NOT SHOWN	61997	1	ENGINE, QSB, 6.7-160 HP, 2200 RPM, 12 VOLT, SPEED CONTROL	
NOT SHOWN	60799-17	1	TRANSMISSION, ALLISON, 3000 SERIES, TC-417	
NOT SHOWN	62192	1	SHIFTER, TRANSMISSION, PUSH BUTTON	
1	62210	1	ENGINE CRADLE, QSB TIER III	
2	62185	1	TCM, 1ST THROUGH 5TH SPEED, 1950 SHIFT CAL	
3	60981	1	MOUNT, REAR ENGINE, LEFT HAND	
4	60982	1	MOUNT, REAR ENGINE, RIGHT HAND	
5	80240	12	BOLT, HEX HEAD, M12 X 1.5 X 35MM, 10.9	
6	82530	2	BOLT, HEX HEAD, 3/4-10 X 4 1/2 LONG	
7	85095	2	WASHER, 3/4-10	
8	60740	2	WASHER, 3/4-10 (REAR ENGINE MOUNT)	
9	60136	2	ISOLATOR, REAR ENGINE	
10	60740-1	2	WASHER, 3/4-10 (REAR ENGINE MOUNT)	
11	85029	2	LOCKNUT, NYLON, 3/4-10	
12	82508	2	BOLT, 3/4-16 X 4 LONG	
13	85095	2	WASHER, 3/4-16	4 (FIELD)
14	85029	2	LOCKNUT, NYLON, 3/4-10	
15	61574	1	DIPSTICK, TRANSMISSION	
16	82437	1	BOLT, HEX HEAD, 5/16-18 X 2 1/2 LONG?	FROM FIELD
17	85090	6	WASHER, 5/16-18?	FROM FIELD
18	42197	2	P-CLAMP, 3/4"?	FROM FIELD
19	12091	1	SPACER, DIPSTICK CLIP	
20	85024	1	LOCKNUT, NYLON, 5/16-18?	FROM FIELD
21	62126	1	CLIP, DIPSTICK RETAINER	
22	42070	2	SPACER, ENGINE CRADLE	
23	82519	2	BOLT, 3/4-16 X 4 1/4 LONG	
24	85095	2	WASHER, 3/4-16	4 (FIELD)
25	85029	2	LOCKNUT, NYLON, 3/4-10	
REV	DATE	BY		SHEET
D	06/03/2016	MPC		1 OF 3
TICO MANUFACTURING - RIDGELAND, SC 29936				

TICO PRO-SPOTTER				
S/N:		ASSEMBLY, ENGINE & TRANSMISSION		72287
ITEM	PART #	QTY/M	DESCRIPTION	
26	60809	1	MOUNTING PLATE, FRONT ENGINE	
27	80341	1	BOLT, M16 X 2 X 45MM, 12 PT HEAD, 10.9	
28	82474	2	BOLT, 5/8-11 X 3 1/4 LONG	
29	85094	3	WASHER, 5/8-11	
30	60113	2	WASHER, 5/8-11 X 3 OUTER DIAMETER	
31	60814	4	ISOLATOR, FRONT ENGINE MOUNT	
32	10971	2	SPACER, FRONT ENGINE MOUNT	
33	85028	2	LOCKNUT, NYLON, 5/8-11	
34	90910	1	BRACKET SUPPORT, POSITIVE & NEGATIVE CABLES	
35	91069	1	SENSOR, WATER TEMPERATURE GAUGE	
36	91068	1	SENSOR, OIL PRESSURE GAUGE	
37	40467	1	FITTING, TEE STREET, 1/8 NPT	
38	60061	1	PRESSURE STAT, 10 PSI	
39	62101	1	BRACKET, ANGLE FOR HOSE, QSB TIER III	
40	60956	3	BRACKET, TRANSMISSION HOSE	
41	82382	3	BOLT, HEX HEAD, 5/16-18 X 1 1/4 LONG?	FROM FIELD
42		3	LOCKNUT, 5/16-18?	FROM FIELD
43	40593	3	P-CLAMP, 1"?	FROM FIELD
44	85090	3	WASHER, 5/16-18?	FROM FIELD
45	85024	3	LOCKNUT, NYLON, 5/16-18?	FROM FIELD
46	60747	1	PEDAL ACCELERATOR, ELECTRONIC QSB	
47	85090	2	WASHER, 5/16?	FROM FIELD
48	85024	2	LOCKNUT, NYLON, 5/16?	FROM FIELD
49	90632	1	MOUNTING PLATE, ELECTRIC THROTTLE	
50	83318	2	SCREW, SC HC, 3/8-16 X 3 1/2 LONG	
51	85113	4	WASHER, FLAT, 3/8-16	
52	85036	2	LOCKNUT, NYLON, 3/8-16	
NS	61680	1	HARNESS, ENGINE CRADLE	
NS	61513	1	HARNESS, TRANSMISSION, EXTERIOR	
NS	91134	1	WIRE, 6GA, GROUND 31/3/4", ENGINE/FRAME	
NS	90798	1	CABLE, POSITIVE, 2GA RED X 42", 5/16-3/8 ENDS	
NS	91133	1	CABLE, GROUND, ALTERNATOR TO STARTER	
REV	DATE	BY		SHEET
D	06/03/2016	MPC		2 OF 3

TICO MANUFACTURING - RIDGELAND, SC 29936

