

ACCELERATOR PEDAL

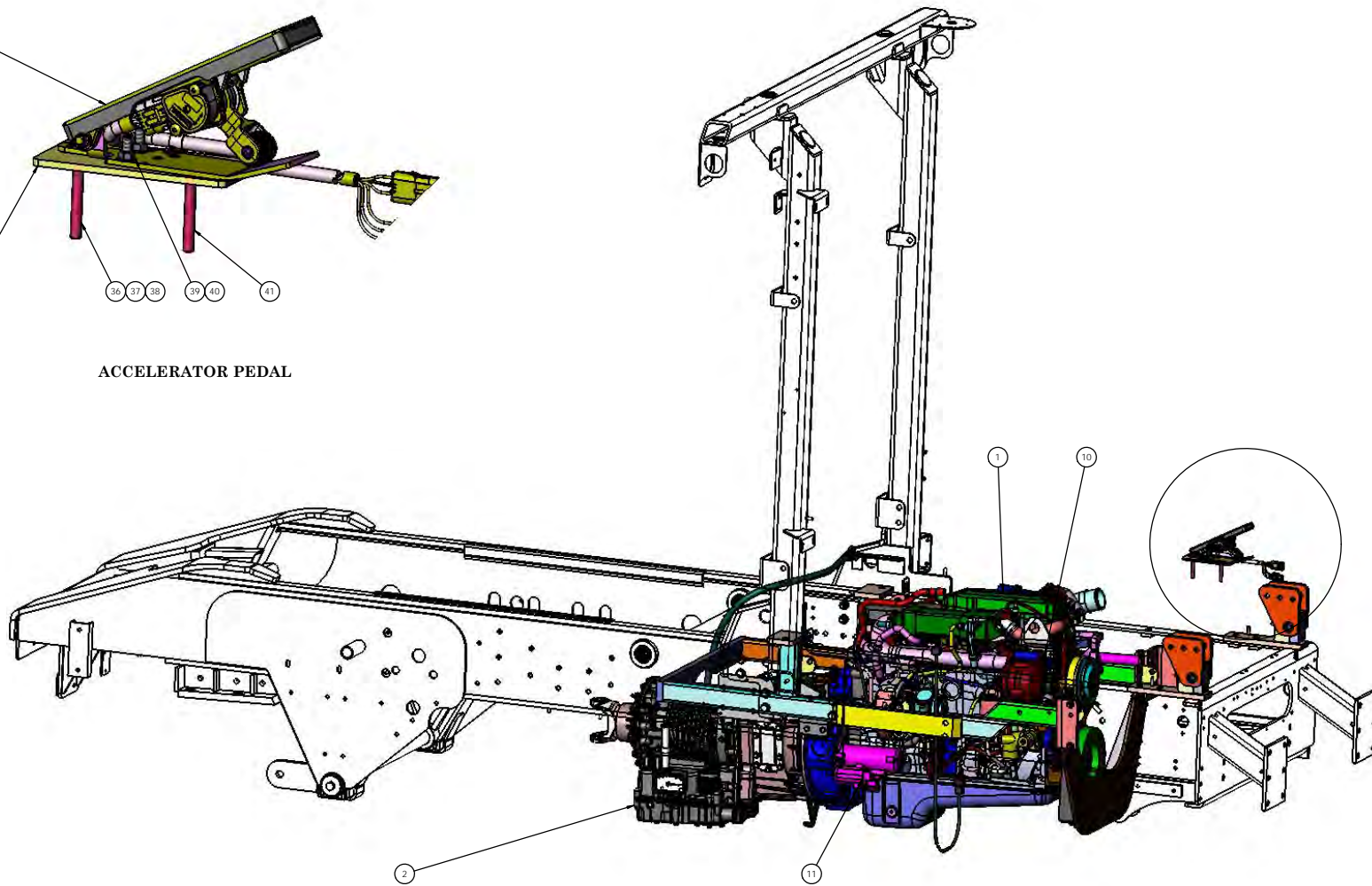

ENGINE & TRANSMISSION  
 PAGE 1 GENERAL OVERVIEW  
 PAGE 2 DETAIL VIEWS  
 PAGE 3-5 PARTS LIST

DIMENSIONS ARE IN INCHES		NAME	DATE
TOLERANCES:	DECIMALS	DRAWN	MAL 12/26/2017
FRONTS:	± .005	CHECKED	
BACKS:	± .005	APPROVED	
ANGULAR:	± 0.1°	DOTTED SCALE DRAWING	
FRACTIONAL:	± 1/32"	THE SUBJECT MATTER SHOWN AND DESCRIBED IN THE DRAWING AND ANY OTHER INFORMATION CONTAINED HEREIN IS THE PROPERTY OF WIPAC AND IS TO BE USED FOR THE PURPOSES SPECIFIED ONLY. ALL RIGHTS TO ANY PATENTS, TRADE SECRETS, OR OTHER INTELLECTUAL PROPERTY ARE RESERVED TO WIPAC MANUFACTURING, INC.	
UNLESS NOTED OTHERWISE		TITLE: ENGINE & TRANSMISSION	
SCALE:	N/A	SIZE	DWG. NO. 728318-R1
REV:		SCALE	1:32 [WEIGHT: 5521.03] SHEET 1 OF 2
REVISIONS:		REV	
SEE NOTE			
REVISION:			

D 728318-R1

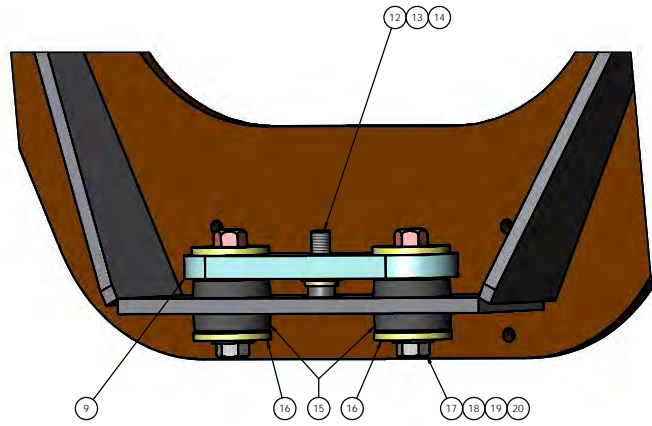

**FRONT MOTOR MOUNT**

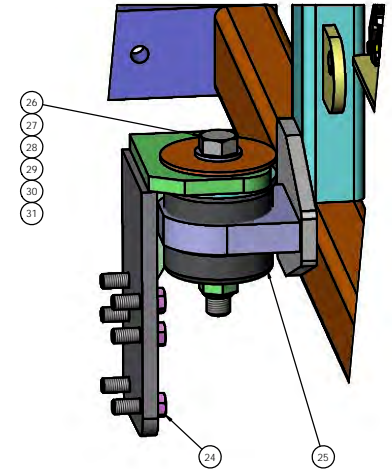

**REAR MOTOR MOUNT**

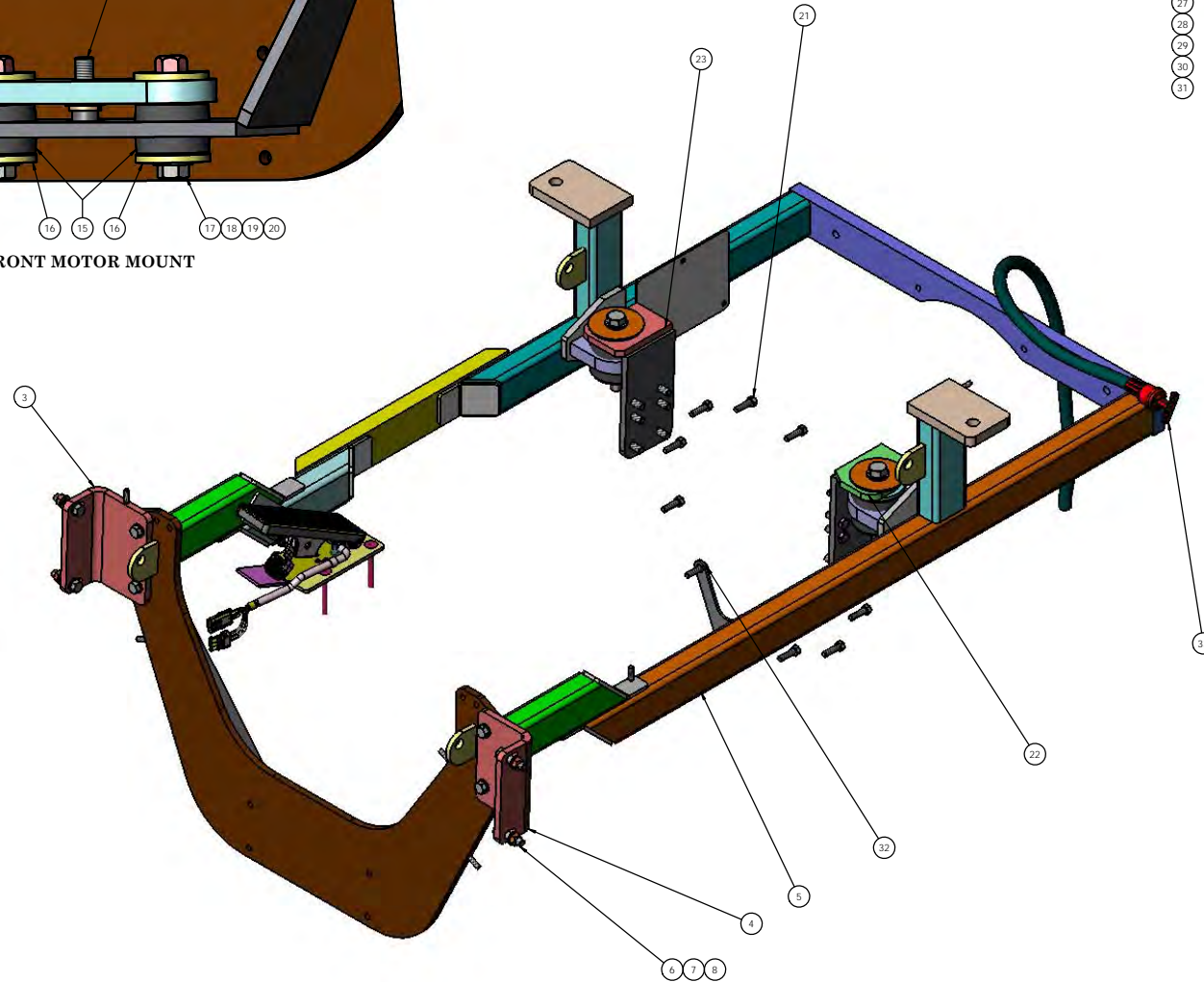

REFERENCES ARE IN INCHES	DATE	10/26/2017		TICO/TERMINAL SERVICE 66 CYPRUS ROAD DR. ROCKLAND, SC 29769 (843) 717-2226
DIMENSIONS: FINISH: TYP. & DIM. TYP. & DIM. TYP. & DIM. FINISHING:	DRAWN CHECKED APPROVED	REVISIONS: REVISIONS: REVISIONS: REVISIONS: REVISIONS:		
DIMENSIONS: FINISH: TYP. & DIM. TYP. & DIM. TYP. & DIM. FINISHING:	DRAWN CHECKED APPROVED	REVISIONS: REVISIONS: REVISIONS: REVISIONS: REVISIONS:	SIZE [DWG. NO.] <b>D</b> [722318-R1]	REV SCALE: 1:32 [WEIGHT: 5521.03] SHEET 2 OF 2

D 722318-R1

TICO PRO-SPOTTER				
ENGINE&TRANS 2017III, B6.7,2°,ALU W/WATER TRANS RAD,CAC, DIR FAN,LOWER RAD, ALT				722318
ITEM	PART #	QTY/M	DESCRIPTION	
1	620859	1	ENGINE-QSB6.7-IV-158HP @ 2100RPM, BLK HTR, W/AC, WO ALT & START	
2	60984	1	TRANSMISSION,3500 RDS,ELECTRONIC, TC-417, W/TRANS ADPT.	
NS	620997	1	TCM-RDS3500, 2-5, 2016 CUM QSB III/IV, 12.28, 12V	
NS	62192	1	SHIFTER-PUSH BUTTON GEN-V	
3	61572-5	1	MOUNT BRACKET-FRONT ENGINE FRAME	
4	61572-9	1	BRACKET FRONT ENGINE MOUNT	
5	62115-R	1	ENGINE CRADLE, RAW	
6	82418	8	BOLT, HEX HD 1/2-13 x 2	
7	85027	8	LOCKNUT, NYLOCK, 1/2"-13, ZINC PLT	
8	85093	16	WASHER, FLAT, 1/2", SAE, GRD 8, ZINC PLT	
9	60809-2	1	MOUNTING PLATE FRONT ENGINE MOUNT	
10	620654	1	ALTERNATOR, 160 AMP, PIVOT MNT, 24SI, DELCO	
11	91243	1	STARTER-ENGINE MT-35 2013-ISB	
NS	60799-6	6	BOLT, M10 X 1.5, 30MM LONG, FLEXPLATE, 300RDS TRANS	
NS	85091	2	WASHER, FLAT, 3/8", SAE, GRD 8, ZINC PLT	
12	80341	1	BOLT, SOC HD , M16 x 2.0, 45MM LG, BLK OXIDE	
13	850204	1	WASHER, WEDGE LOCK, 5/8"/M16, ZINC FLAKE	
14	85094	2	WASHER, FLAT, 5/8", SAE, GRD 8, ZINC PLT	
15	60814	4	ISOLATOR,ENGINE FRONT DUAL	
16	60113	2	WASHER 3X5/8	
17	10971	2	SPACER FRONT MOTOR MOUNT QSB-III/ISB-07	
18	82474	2	BOLT 5/8-11X3-1/4" HHCS	
19	85094	2	WASHER, FLAT, 5/8", SAE, GRD 8, ZINC PLT	
20	850192	2	NUT, NYLOCK, 5/8-11NC-2B THD, THIN	
NS	60799-6	6	BOLT, M10 X 1.5, 30MM LONG, FLEXPLATE, 300RDS TRANS	
21	60799-12	1	FLYWEEL HOUSING BOLT KIT	
REV	DATE	BY		SHEET
R	10/18/19	REB		1 OF 2

TICO PRO-SPOTTER				
ENGINE&TRANS 2017III, B6.7,2°,ALU W/WATER TRANS RAD,CAC, DIR FAN,LOWER RAD, ALT				722318
ITEM	PART #	QTY/M	DESCRIPTION	
22	60981	1	MOUNT MOTOR BRACKET QSB-III L-H 2 DEG	
23	60982	1	MOTOR MOUNT BRACKET QSB3, RH 2DEG	
24	80240	12	M-12 x 15 x 35MM HEX HEAD 10.9 (APPLY LOCKTITE & TORQUE BOLTS TO 40 FT-LB)	
25	61678	2	ISOLATOR REAR ENGINE	
26	61677-8	2	SPACER FOR REAR ENGINE ISOLATOR	
27	60740	2	SPACER,REAR MOTOR MOUNT 1/4" THK,13/16IDX3.75OD	
28	85095	2	WASHER, FLAT, 3/4", SAE, GRD 8, ZINC PLT	
29	60740-1	2	SPACER,REAR MOTOR MOUNT 1/8" THK,13/16IDX3.75 OD	
30	82530	2	BOLT, HEX HD 3/4-10 X 4 1/2" LG, GRD 8	
31	85029	1	LOCKNUT, NYLOCK, 3/4-10	
32	90910	1	BRACKET, SUPPORT POS./NEG BATTERY CABLES	
33	61574	1	DIPSTICK,TRANSMISSION,SIDE CHECK ,3000/3500RDS	
NS	12091	1	SPACER-DIPSTICK	
NS	85024	1	LOCKNUT, NYLOCK, COARSE, 5/16-18, GRD 8	
NS	42050	1	FITTING-TEE,BRANCH, 3/4 NPT, BRASS	
NS	42055	1	FITTING-ELBOW, 1 HOSE BARB X 3/4 NPTM, 45 DEG, STEEL	
NS	85024	1	LOCKNUT, NYLOCK, COARSE, 5/16-18, GRD 8	
NS	62126	1	CLIP-DIPSTICK RETAINER	
NS	800458	1	M8-2.12 x 20MM HEX WASHER HEAD TAPPING SCREW	
NS	42178	1	HOSE BARB-BRASS-90 DEGREE 5/8 HOSE TO 1/2 PIPE	
NS	60061	1	PRESSURE STAT 10 POUND	
NS	40467	1	FITTING, BRASS TEE	
NS	12091	1	SPACER-DIPSTICK	
NS	620625-1	1	HARNESS-WIRE, 2017 ENGINE, TIER IV FINAL, FRONT MOUNT PDC, CONVOLUTED TUBING	
NS	620630	1	HARNESS-2017 GEN IV ALLISON TRANSMISSION, CAB MOUNTED	
NS	91221	1	CABLE 2 GA RED ALT TO STARTER 38"	
NS	910601	1	HARNESS-WIRE, AIR INTAKE HEATER TO PDC, TIER IV, 2017 CAB	
NS	91232	1	WIRE ASSY, 6GA, BLACK, 5/16-3/8 LUGS, ECM GRD/BATT 121" OAL	
NS	910621	1	CABLE - 2 GAUGE, RED, 1/4" x 3/8" LUGS x 42" LG	
34	61640	1	PEDAL ACCELERATOR ISB 2013	
35	121418	1	ASSEMBLY, MOUNTING PLATE ELECTRIC THROTTLE (2017 CAB)	
NS	910792	1	CABLE - 2GA BLACK, 5/16" R TO 1/2" R X 38" LG	
<b>REV</b>	<b>DATE</b>	<b>BY</b>		<b>SHEET</b>
R	10/18/19	REB		2 OF 3

