

LEFT VIEW

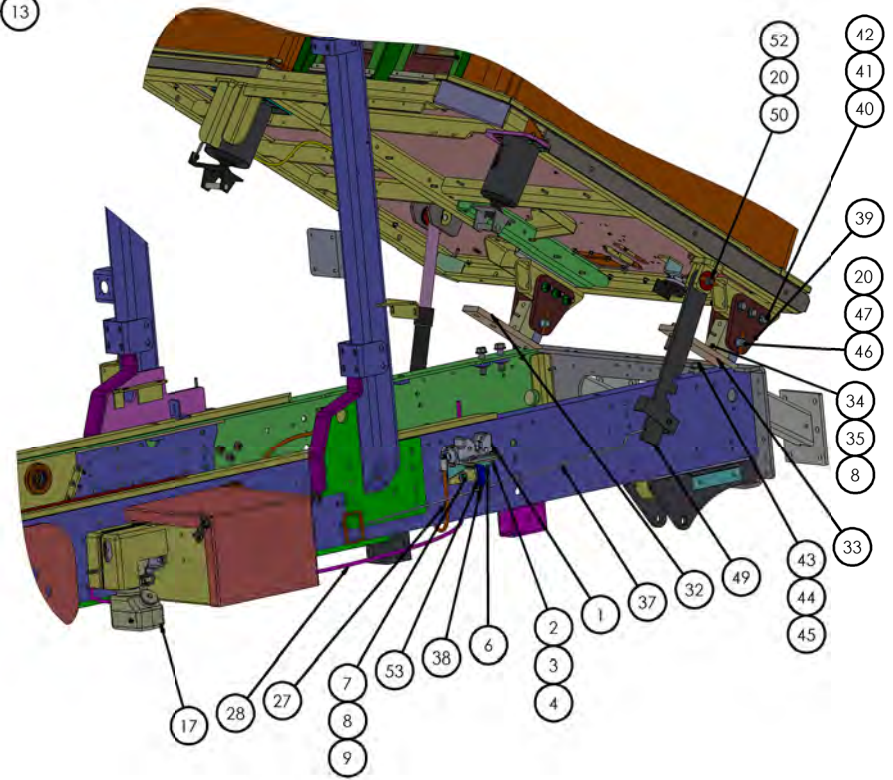

RIGHT VIEW

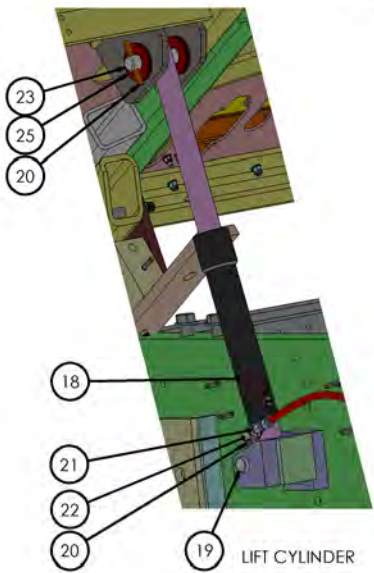

LIFT CYLINDER

DIMENSIONS ARE IN INCHES		NAME	DATE	 TICO MANUFACTURING 4401 CYPRESS FLORES CR. ROCK HILLS, SC 29730 (843) 717-2222
DESIGNED	BY	DATE		
DRAWN	BY	DATE		
CHECKED	BY	DATE		
APPROVED	BY	DATE		
REVISIONS	DESCRIPTION	DATE		
1				
2				
3				
4				
5				
6				
7				
8				
9				
10				
11				
12				
13				
14				
15				
16				
17				
18				
19				
20				
21				
22				
23				
24				
25				
26				
27				
28				
29				
30				
31				
32				
33				
34				
35				
36				
37				
38				
39				
40				
41				
42				
43				
44				
45				
46				
47				
48				
49				
50				
51				
52				
53				

TITLE: CAB SUSPENSION

SHEET 1 OF 1

TICO PRO-SPOTTER				
CAB SUSPENSION, 2017-III CAB, PAINTED				722214
ITEM	PART #	QTY/M	DESCRIPTION	
1	30096-1	2	LATCH, CAB CUSHION AIR RIDE	
NOT SHOWN	30096-5	2	WASHER, BUSHING RETAINER CAB CUSHION	
2	82383	8	BOLT, HEX, 3/8-16 X 1-1/4 LG	
3	85091	16	WASHER, FLAT, 3/8	
4	85036	8	LOCKNUT, NYLOCK, 3/8-16	
5	20157	1	BRACKET, CAB CUSHION WELDMENT, LH	
6	20158	1	BRACKET, CAB CUSHION WELDMENT, RH	
7	82396	6	BOLT, HEX, 1/2-13 X 1-1/2 LG	
8	85038	6	LOCKNUT, NYLOCK, 1/2-13	
9	85115	12	WASHER, FLAT, 1/2	
10	40468	2	FITTING TEE 1/4" NPT X 1/4" JIC X 1/4" JIC, STEEL	
11	10625	2	FITTING, ADAPTER BRASS STRAIGHT 1/4 x 1/4	
12	30096-2	1	ASSEMBLY, AIRBAG LARGE	
13	30096-3	1	ASSEMBLY, AIRBAG SMALL	
NOT SHOWN	30096-5	2	WASHER, BUSHING RETAINER CAB CUSHION	
2	82383	8	BOLT, HEX 3/8-16 X 1-1/4 LG AIRBAGS	
3	85091	16	WASHER, FLAT, 3/8	
4	85036	8	LOCKNUT, NYLOCK, 3/8-16	
17	200441	1	CAB LIFT PUMP,REMOTE SWITCH, RESISTIVE CHECK VALVE, NO BATTERY CABLE	
NOT SHOWN	620741	1	HARNESS-WIRES,EXTENSION, CAB TILT SWITCH, LP/CNG	
18	300377	1	CYLINDER, CAB LIFT HYDRAULIC, SAE O-RING PORT	
19	10071-4	1	PIN, CAB LIFT CYLINDER LOWER	
20	40018	1	PIN,3/8 ROLL	
21	42001	1	STRAIGHT ADAPTER 1/4 O-RING TO 1/4 JIC	
22	420314	1	VALVE, VELOCITY FUSE,90° SWIVEL, 0.2 TO 4.0 GPM, CLOSING FLOW 0.8 GPM	
23	90341	1	PIN - UPPER LIFT CYLINDER	
20	40018	1	PIN - 3/8 ROLL	
25	85119	9	WASHER, FLAT 1"	
NOT SHOWN	61821	1	HARNESS-CAB LIFT POWER	
26	41151	1	HOSE ASSY- NO 4, OAL 41 1/2LG, STR/90°	
27	410364	1	HOSE ASSY - NO 4, ELBOW 90°/STR, OAL 95-1/6" LG	
28	41228	1	HOSE ASSY-NO 4, OAL 80 1/2LG, STR/90°	
REV	DATE	BY		SHEET
A	3/8/2019	MAL		1 OF 3

TICO PRO-SPOTTER				
CAB SUSPENSION, 2017-III CAB, PAINTED				722214
ITEM	PART #	QTY/M	DESCRIPTION	
29	40833	1	FITTING, STR ADAPTER, 3/8" NPTM X 1/4" TUBE, PUSH-ON, BRASS	
30	11000	20 IN	TUBE, 1/4 OD AIR BRAKE (YELLOW)	
NOT SHOWN	41069	1	LOOM 1/4" ID - DELL CITY P/N 783	
NOT SHOWN	41069	1	LOOM 1/4" ID - DELL CITY P/N 783	
31	12245	1	SWITCH-CAB PUMP TTC-1 W/ MALE W/P CONN	
NOT SHOWN	122256	1	SWITCH- BRACKET	
NOT SHOWN	82382	2	BOLT, HEX HEAD-5/16-18NC X 1 1/4"LG	
NOT SHOWN	85024	2	NUT-NYLOCK 5/16	
32	121021	1	BLOCK ASS'Y, LH CAB PIVOT, GALV	
33	121020	1	BLOCK ASS'Y, RH CAB PIVOT, GALV	
34	82528	4	BOLT, HEX, 1/2-13 X 4-1/4 Lg	
35	85093	8	WASHER, FLAT, 1/2	
8	85038	4	LOCKNUT, NYLOCK, 1/2-13	
37	122571-1	1	CAB LATCH HANDLE, 2017 B6.7, STRAIGHT, BLACK, ORANGE CONTRAST	
NOT SHOWN	85093	2	WASHER, FLAT, 1/2	
NOT SHOWN	80148	1	COTTER PIN, 1/8	
38	41273	1	CLAMP, P 1/2" ID	
NOT SHOWN	82359	1	BOLT, HEX, 1/4-20 X 3/4 Lg	
NOT SHOWN	85023	1	LOCKNUT, NYLOCK, 1/4-20	
NOT SHOWN	85089	2	WASHER, FLAT, 1/4	
39	122020	4	ASSEMBLY, CAB PIVOT RH 1" FLANGED BUSHING	
40	82595	6	BOLT, HEX, 5/8-11 X 6 Lg	
41	85028	6	LOCKNUT, NYLOCK, 5/8-11	
42	85094	12	WASHER, FLAT, 5/8	
43	82464	4	BOLT 3/4-10 X 3 Lg	
44	85040	4	LOCK NUT 3/4-10	
45	85117	8	WASHER, FLAT 3/4	
46	90688	2	BUSHING, MOD RUBBER CAB PIVOT 2.06 OD	
47	121010	2	PIN, CAB PIVOT	
20	40018	4	PIN, 3/8 ROLL x 2"	
49	12361	1	LATCH, CAB SAFETY BAR	
50	10945-3	1	PIN, 1" CAB SAFETY LATCH BAR	
20	40018	2	PIN, 3/8 ROLL x 2"	
52	85098	2	WASHER, FLAT 1"	
NOT SHOWN	12168	1	DECAL-CAB PUMP INSTRUCTIONS	
REV	DATE	BY		SHEET
A	3/8/2019	MAL		2 OF 3

