

DIMENSIONS ARE IN INCHES		NAME	DATE
TOLERANCES	DECIMAL	DRAMAN	MAL
			6/1/2018
		CHECKED	
		APPROVED	
		DOTTED SCALE DRAWING	
		THE SUBJECT MATTER SHOWN AND DESCRIBED IN THE DRAWING AND ANY OTHER INFORMATION CONTAINED HEREIN IS THE PROPERTY OF WECO AND IS TO BE KEPT IN CONFIDENCE BY THE RECIPIENT. ALL RIGHTS TO ANY PATENTS, TRADEMARKS, OR OTHER INTELLECTUAL PROPERTY ARE RESERVED TO WECO MANUFACTURING, INC.	
SCALE:	N/A	SIZE	DWG. NO.
REV:	SEE NOTE	D	721969-81
SECRET:	N/A	SCALE:	1:32 [WEIGHT: 5103.20] SHEET 1 OF 2
		TITLE:	COVERS & GRATINGS
		REV	

D 721969-81

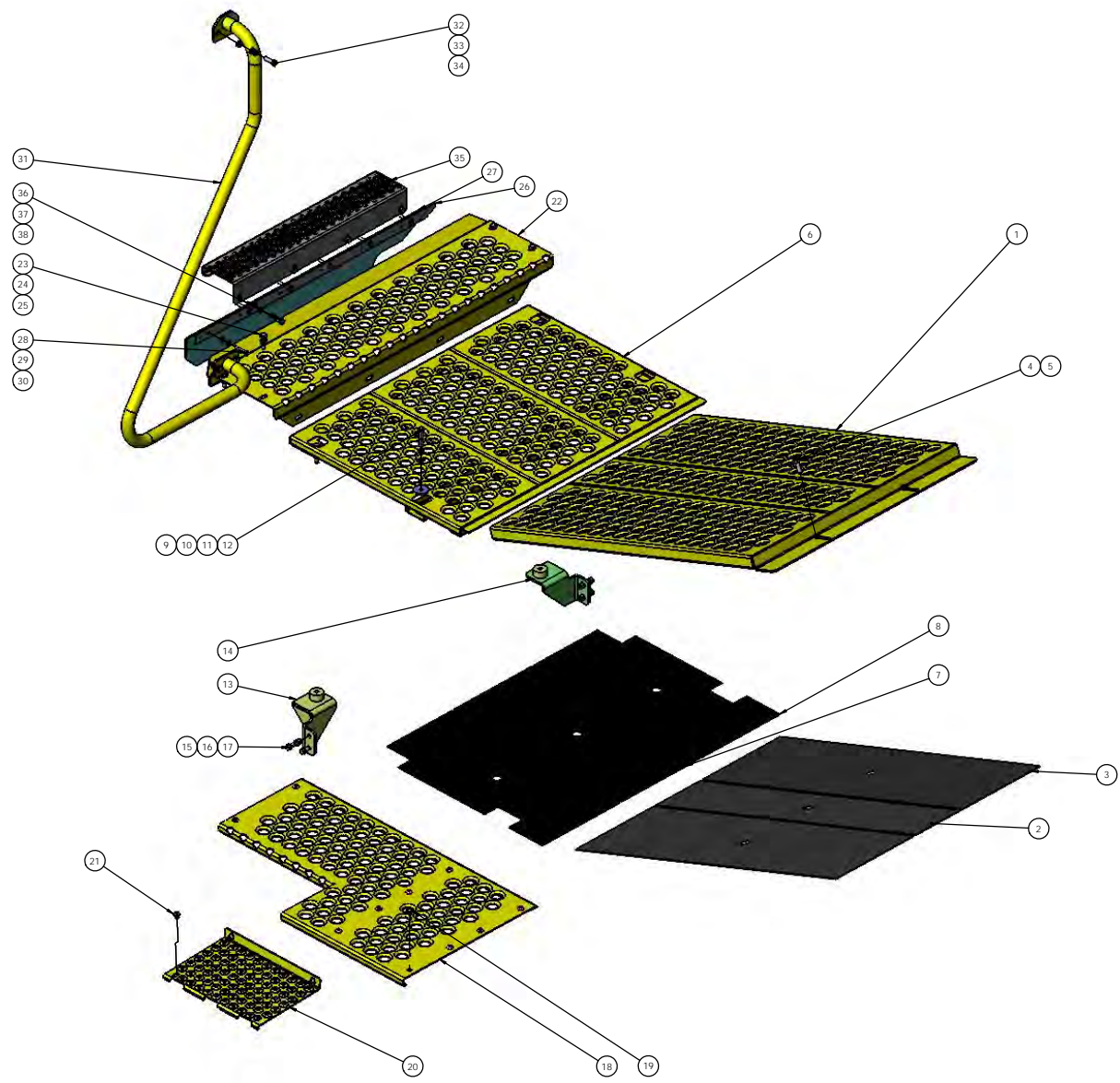

REFERENCES ARE IN INCHES	UNITS	DATE	TICCI/TERMINAL SERVICE
DESIGNER	SCALE	6/1/2018	840 CYPRUS RIDGE DR.
BY			ROCKLAND, SC 29588
CHECKED			(843) 717-2226
PROJECT NO.			
PROJECT NAME			
PROJECT SCALE			
REVISIONS			
REVISION NO.	DESCRIPTION	DATE	
1			
2			
3			
4			
5			
6			
7			
8			
9			
10			
11			
12			
13			
14			
15			
16			
17			
18			
19			
20			
21			
22			
23			
24			
25			
26			
27			
28			
29			
30			
31			
32			
33			
34			
35			
36			
37			
38			

TITLE: COVERS & GRATINGS
 SIZE: D
 DWG. NO.: 721969-B1
 REV: 1
 SCALE: 1:32
 WEIGHT: 5103.25
 SHEET 2 OF 2

TICO PRO-SPOTTER				
COVERS & GRATINGS, 2017-III CAB, QSB-IV & QSB-III, 128" WB, SAFETY YELLOW				721969
ITEM	PART #	QTY/M	DESCRIPTION	
	722095-A1	REF	COVERS & GRATINGS, 2017-III CAB, QSB-IV & QSB-III, 128" WB, SAFETY YELLOW	
1	30293	1	COVER, BOOM, WELDMENT, OPEN GRIP PATTERN, TICO ORANGE	
2	30249	1	HEAT SHIELD, 7"	
3	30250	2	HEAT SHIELD, 12"	
4	82383	2	BOLT, HEX 3/8"-16 x 1 1/2" LG	
5	85091	2	WASHER, FLAT 3/8" - HARDENED	
6	300474	1	GRATING, TRANS COVER ASSY, OPEN GRIP, 128" WB, 2017 CAB, QSB-III, TICO ORANGE	
7	300477	1	HEAT SHIELD, 2017 TRANSMISSION COVER MIDDLE, 128" WB	
8	300478	2	HEAT SHIELD, OUTER, 2017 TRANSMISSION COVER, 128" WB	
9	50162-9	4	WASHER, 1 5/8" OD x 13/32" ID x 1/8" THICK	
10	85091	4	WASHER, FLAT 3/8"	
11	85135	4	LOCKWASHER, HELICAL, 3/8	
12	82416	4	BOLT, HEX, 3/8-16 X 2 LG	
13	122473	1	BRACKET, TRANS COVER, 2017 CHASSIS PDC, LHS	
14	122476	1	BRACKET, TRANS COVER, 2017 CHASSIS PDC, RHS	
15	82405	4	BOLT, HEX, 3/8-16 X 1-3/4" LG	
16	85091	8	WASHER, FLAT, 3/8	
17	85025	4	LOCKNUT, NYLOCK, 3/8-16	
18	30298	1	GRATING, STEP FORWARDFUEL TANK TOP, OPEN GRIP PATTERN, YELLOW RAL #1003	
19	80378	10	CAPSCREW, 3/8-16 UNC X 1/2 LG BUTTONHEAD, SS	
20	30299	1	GRATING, FUEL TANK STEP, CIRCLE PATTERN, TICO ORANGE	
21	80378	4	CAPSCREW, 3/8-16 UNC X 1/2 LG BUTTONHEAD, SS	
22	121563	1	ASSEMBLY, CAB STEP, 2017 CAB, YELLOW RAL 1003	
23	80317	4	BOLT, HEX 3/8"-16 x 1-1/2" Lg SS	
24	85091	4	WASHER, FLAT, 3/8"	
25	85025	4	LOCKNUT, NYLOCK 3/8"-16	
26	122550	1	CLAMP PLATE, BAFFLE, 2017 FLOOR	
27	910534	1	BAFFLE, REAR SOUND DAMPNER, 2017 FLOOR	
28	82403	6	BOLT, HEX 1/4"-20 x 1 3/4" Lg RUBBER to FLOOR	
29	85089	12	WASHER, FLAT 1/4"	
30	85023	6	LOCKNUT, NYLOCK, 1/4"-20	
REV	DATE	BY		SHEET
B	7/1/2020	MAL		1 OF 2

