

TR-3 INVERSION VALVE

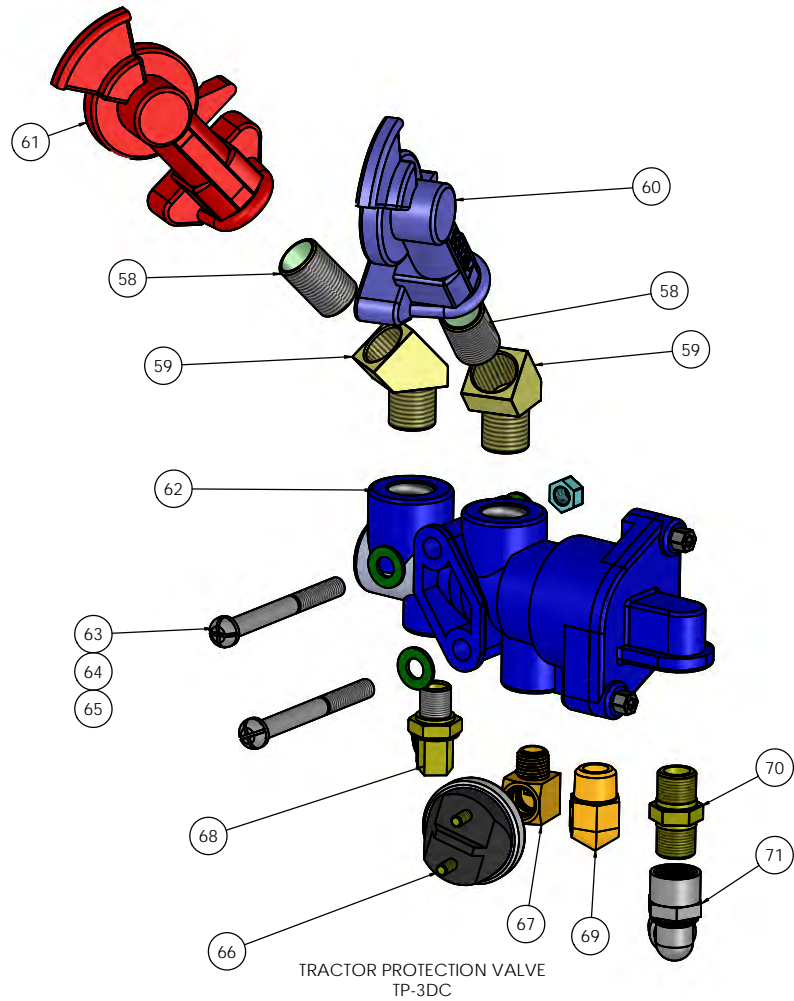

TRACTOR PROTECTION VALVE  
TP-3DC

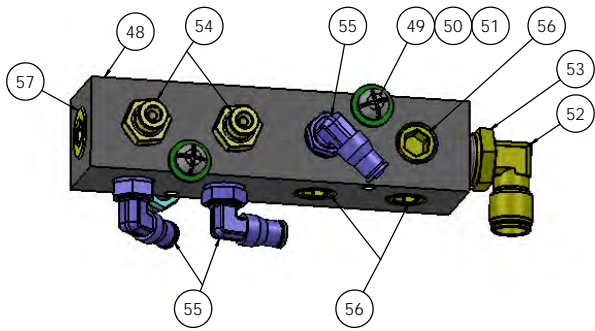

AIR MANIFOLD

DIMENSIONS ARE IN INCHES TOLERANCES: DECIMALS .0000 FRACTIONS 1/32" & 1/16" ANGULAR ±0.1° HORIZONTAL GEOMETRIC TOLERANCING PER ASME Y14.5M-1994	NAME: MAL DATE: 5/21/2019 CHECKED: APPROVED: DOTTED SCALE DRAWING THE SUBJECT MATTER SHOWN AND DESCRIBED IN THE DRAWING AND ANY OTHER INFORMATION IS UNLESS OTHERWISE SPECIFIED IS TO BE CONSIDERED AS NOT BEING A PART OF THE CONTRACT. THIS DRAWING AND CONTENTS HEREOF ARE SOLELY THE PROPERTY OF TICO MANUFACTURING AND SHALL REMAIN THE PROPERTY OF TICO MANUFACTURING.	TICO MANUFACTURING 66 CYPRUS ROAD DR. ROCKLAND, NC 27854 TICO@TRACTORS.COM
TITLE: AIR SYSTEM-2016, DOI-121, 3 TANK, MV3 ABS HOSES, CAST IRON GLADHANDS	SIZE: D DWG. NO.: 721854-A1 AIR SYSTEM SCALE: 1:24 [WEIGHT: SHEET 3 OF 3	REV:



**TICO PRO-SPOTTER**

**AIR SYSTEM-2016, DOT-121, 3 TANK, MV3, ABS, HOSES, CAST IRON GLAD HANDS**

**721854**

ITEM	PART #	QTY/M	DESCRIPTION	
24	40550	1	VALVE-BRAKE QUICK RELEASE QR-1	
25	81546	2	CAPSCREW-5/16-18NC X 1 1/4LG	
26	85101	2	WASHER, FLAT5/16	
27	85024	2	LOCKNUT, 5/16-18 NYLOK	
28	40864	2	FITTING, STR BRASS 3/8 TUBE, 3/8NPT	
29	42064	1	FITTING, ELBOW 90°, BRASS 1/2 TUBE, 1/2NPT	
30	40572	1	VALVE-BOBTAIL/PROPORTIONING BP-R1 W/BRACKET	
31	81535	2	BOLT-5/16 X 1	
32	85090	4	WASHER-5/16	
33	85035	2	NUT-5/16	
34	40830	1	FITTING, ELBOW 45°, BRASS, 1/2 TUBE X 1/2 NPT	
35	42064	2	FITTING, ELBOW 90°, BRASS 3/8 TUBE to 1/2 NPT, SWIVEL	
36	42063	1	FITTING, ELBOW 90°, BRASS, 3/8 TUBE to 1/4 NPT	
37	42112	1	FITTING, ELBOW 90°, BRASS, 3/8 TUBE to 1/8 NPT	
38	80163	1	FITTING, PLUG ALLEN, BRASS 1/2" NPT	
39	40841	1	FITTING, PLUG ALLEN, BRASS 3/8" NPT	
40	40840	1	FITTING, ELBOW 90°, BRASS, 3/8 TUBE to 1/8 NPT	
41	10592	1	VALVE-BRAKE QUICK RELEASE QR-1C	
42	81546	2	CAPSCREW-5/16-18NC X 1 1/4LG	
43	85024	2	LOCKNUT-5/16	
44	40864	1	FITTING-STR BRASS 3/8 TUBE X 3/8 NPT	
45	40823	1	FITTING-90° BRASS 3/8 TUBE X 3/8 NPT	
46	42063	1	FITTING-90° BRASS 3/8 TUBE X 1/4 NPT	
47	40857	1	FITTING-90° BRASS 1/4 TUBE X 1/4 NPT	
48	10949	1	MANIFOLD-ASS'Y AIR	
49	82459	2	CAPSCREW-5/16-18 X 3 LG HEX HD	
50	80232	2	WASHER, FLAT 5/16	
51	85209	2	LOCKNUT, 5/16-18	
52	42133	1	FITTING, ELBOW 45° BRASS, 3/8 TUBE X 1/2 NPT, SWIVEL	
53	42090	1	FITTING, REDUCER BRASS 1/2NPT TO 1/4 NPT	
54	40833	2	FITTING, STR BRASS, 1/4 TUBE X 3/8 NPT	
55	40887	3	FITTING, ELBOW 90° BRASS 1/4 TUBE X 3/8 NPT, SWIVEL	
56	40841	3	FITTING, PIPE PLUG, BRASS HEX 3/8 NPT	
57	80163	1	FITTING, PIPE PLUG, BRASS HEX 1/2 NPT	
58	40799	2	FITTING, CLOSE NIPPLE BRASS, 1/2 NPT	
59	40899	2	FITTING, STREET ELBOW 90° BRASS, 1/2 NPT	
60	50224	3	GLAD HAND, BLUE SERVICE, CAST IRON	
61	50225	3	GLAD HAND, RED EMERGENCY, CAST IRON	
<b>REV</b>	<b>DATE</b>	<b>BY</b>		<b>SHEET</b>
A	5/20/2019	MAL		2 OF 4

**TICO PRO-SPOTTER**

**AIR SYSTEM-2016, DOT-121, 3 TANK, MV3, ABS, HOSES, CAST IRON GLAD HANDS**

**721854**

ITEM	PART #	QTY/M	DESCRIPTION	
NS	50303	2	HOSE ASSY - TRAILER AIR, 3/8 X 15 FT	
NS	10356	1	SPRING	
NS	920285	1	HOLDER-TRAILER HOSE, 3 CAVITY	
NS	91272	1	SWITCH, PRESSURE, LOW AIR WARNING	
NS	42298	1	FITTING - FEMALE BRANCH TEE, BRASS, 1/4 TUBE X 1/4 NPT	
NS	91271	1	BUZZER, LOW AIR PRESSURE, 75-95 Dba	
62	40635	1	VALVE-TRACTOR PROTECTION TP-3DC	
63	82459	2	BOLT-5/16 X 3 LG	
64	85090	4	WASHER-5/16	
65	85035	2	NUT-5/16	
66	90078	1	SWITCH-PRESSURE, STOP LIGHT, BENDIX SL-5	
67	42208	1	FITTING, STREET ELBOW 90°, 1/4 NPT	
68	42063	1	FITTING, ELBOW 90° BRASS, 3/8 TUBE X 1/4 NPT	
69	40823	1	FITTING, ELBOW 90° BRASS, 3/8 TUBE X 3/8 NPT	
70	40906	1	FITTING, NIPPLE-HEX BRASS, 3/8 NPT	
71	42240	1	FITTING, ELBOW 90° BRASS, 3/8 TUBE X 3/8 NPTF	
72	91966	1	VALVE-INVERSION TR-3	
73	40885	1	FITTING, ELBOW 90° BRASS, 3/8 TUBE X 1/8 NPT, SWIVEL	
74	40861	2	FITTING, ELBOW 90° BRASS, 1/4 TUBE X 1/4 NP, SWIVEL	
75	42273	1	FITTING - UNION TEE, BRASS, 3/8" TUBE	
NS	90295	1	VALVE-AIR REGULATOR	
NS	90295-1	REF		
NS	90295-2	REF		
NS	82370	2	BOLT HEX 1/4-20 X 1 Lg	
NS	85111	4	WASHER, FLAT 3/8	
NS	85034	2	LOCKNUT, 3/8-16	
NS	40817	2	FITTING, STREET ELBOW 90° BRASS, 1/2 NPT	
NS	40687	2	HOSE ASSY -FRONT BRAKE CHAMBER	
NS	62253	1	BRACKET - HOSE GUIDE	
NS	40771	1	VALVE-PRESSURE PROTECTION 70 PSI	
NS	42063	1	FITTING, ELBOW 90° BRASS, 3/8 TUBE X 1/4 NPT	
NS	40871	1	FITTING-NIPPLE, BRASS 1/2NPT	
NS	62460	REF	SCHEMATIC- DOT-121, ABS, MV3, 5TH WHEEL INHIBIT	
REV	DATE	BY		SHEET
A	5/20/2019	MAL		3 OF 4



