

RADIATOR MOUNT DETAIL

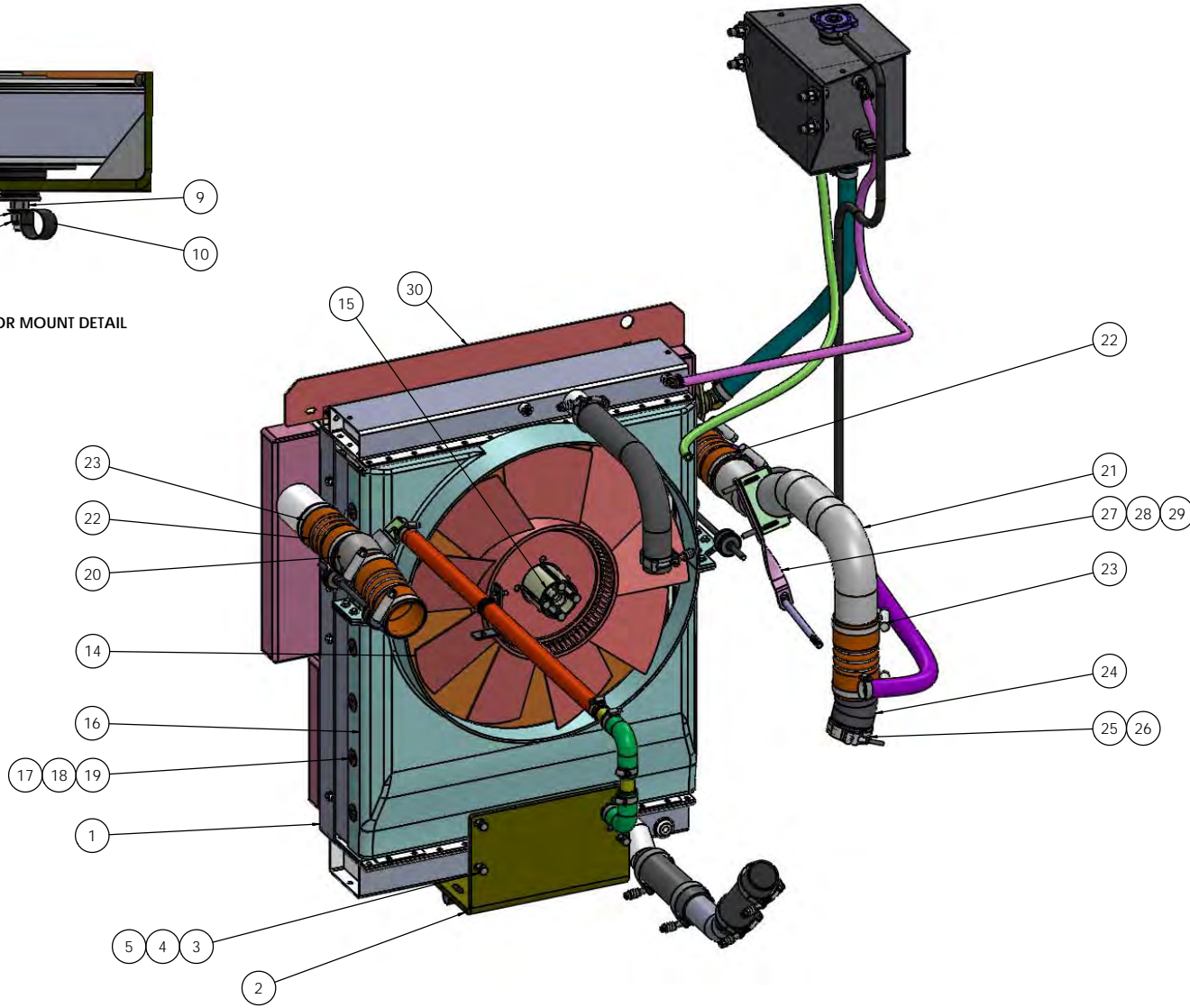

RADIATOR DETAIL & CAC TUBES

COOLING SYSTEM  
 PAGE 1 RADIATOR & TUBES DETAIL  
 PAGE 2 SURGE TANK & HOSES  
 PAGE 3-5 PARTS LIST

DIMENSIONS ARE IN INCHES		NAME	DATE	TICO MANUFACTURING 88 CYPRESS RIDGE DR. ROCKLAND, NC 27854 (843) 717-2226
TOLERANCES:		DRAMAN	1/27/2018	
DECIMAL:		W. B. BOE		
FRACTIONAL:		W. B. BOE		
ANGULAR:		W. B. BOE		
FRACTIONAL:		W. B. BOE		
APPROVED				TITLE
DOTTED SCALE DRAWING				COOLING SYSTEM 2015-2017- ISB, Q5B-IV
THE SUBJECT MATTER SHOWN AND DESCRIBED IN THE DRAWING AND ANY OTHER INFORMATION CONTAINED HEREIN IS THE PROPERTY OF TICO. ALL RIGHTS TO ANY PATENTS, TRADEMARKS, OR COPYRIGHTS ARE RESERVED TO TICO.				SIZE DWG. NO. REV <b>D</b> 721817-A1 SCALE: 1:12 WEIGHT: SHEET 1 OF 2



TICO PRO-SPOTTER				
COOLING SYSTEM, 2015-2017 ISB/QSB-IV				721817
ITEM	PART #	QTY/M	DESCRIPTION	
	721817-A1	REF	COOLING SYSTEM, 2015-2017 ISB/QSB-IV	
1	620586	1	RADIATOR ASSY - W/AC CONDENSER MTG - 1/2" STUDS,BAR/PLATE	
2	12736	1	RADIATOR MOUNT, RUBBER ISOLATORS	
3	82405	4	BOLT, HEX 3/8-16 x 1-3/4" Lg BRKT to ENGINE MT	
4	85091	8	WASHER, FLAT 3/8	
5	85036	4	LOCKNUT - 3/8-16	
6	62254	2	ISOLATOR - RADIATOR MOUNT	
7	85025	2	LOCKNUT, 3/8-16	
8	85091	2	WASHER, FLAT 3/8	
9	85014	2	NUT, HEX 3/8-16	
10	40593	2	CLAMP, P 1.0	
11	80346	4	WASHER, FENDER 3/8" ID x 1 1/2" OD	
12	62110	2	WASHER - FRONT ENGINE MOUNT - BOTTOM	
13	62332	2	WASHER - RADIATOR MOUNT TOP	
14	61842	1	FAN, ENG 22" 9 BLADE COMP 3.75 PW	
15	62173	1	SPACER-FAN 19mm	
NOT SHOWN	62328	1	CAPTURE PLATE	
NOT SHOWN	60799-19	4	BOLT, 10mm x 50mm LG, SERRATED FLANGE HEAD	
NOT SHOWN	85135	4	LOCKWASHER 3/8	
NOT SHOWN	62101	1	BRACKET, TWIST	
16	60988	1	FAN SHROUD	
17	82370	8	BOLT, HEX 1/4-20 X 1" LG SHROUD SIDES	
18	80129	12	WASHER, FENDER 1/4" ID x 1 1/4" OD	
19	85034	12	LOCKNUT 1/4	
NOT SHOWN	40593	2	P-CLAMP	
20	62055	1	TUBE, CAC, ASSEMBLY, LH, ISB13	
21	61968	1	TUBE, CAC, RH, TIER IV	
22	40175	4	HOSE, HUMP	
23	40185	8	CLAMP, CONSTANT TORQUE 2 3/4 - 3 5/8	
24	62048	1	ELBOW, CAC PIPE, ISB	
25	42261	1	CLAMP, V BAND	
26	42262	1	SEAL, O-RING	
27	30337	1	BRACKET, CAC RH TUBE TO ALTERNATOR	
28	40005	1	CLAMP, 3" MUFFLER	
29	80368	1	BOLT, HEX HD 12mm X 160mm LG GRD 8.8 PLATED	
<b>REV</b>	<b>DATE</b>	<b>BY</b>		<b>SHEET</b>
A	1/27/2018	MAL		1 OF 3
<b>TICO MANUFACTURING - RIDGELAND, SC 29936</b>				

TICO PRO-SPOTTER				
COOLING SYSTEM, 2015-2017 ISB/QSB-IV				721817
ITEM	PART #	QTY/M	DESCRIPTION	
30	61644	1	BAFFLE, RADIATOR TOP	
31	61603	2	ROD, THREADED 3/8-16 x 12" LG	
32	60857	8	RUBBER MOUNT, 3/8 ID x 1.75 OD	
33	80346	8	WASHER, FENDER 3/8" ID x 1.75 OD	
34	85102	8	WASHER, FLAT 3/8	
35	85003	4	JAM NUT, 3/8-16	
36	85036	4	NUT, LOCK 3/8	
37	61936	1	SURGE TANK	
38	82407	4	BOLT-1/2-13NC X 1 3/4 LG HEX HD	
39	85115	4	WASHER, FLAT 1/2	
40	85027	4	LOCKNUT, 1/2-13 NYLON	
41	42136	1	FITTING, HOSE BARB STR BRASS, 3/8 HOSE TO 3/8 NPT	
42	42239	2	FITTING, HOSE BARB 90° BRASS, 3/8 HOSE X 3/8 NPT	
43	42148	2	CLAMP, HOSE WORM GEAR 1/4 TO 5/8	
44	42192	65 IN	HOSE, 3/8 (ENGINE TO SURGE TANK)	
45	42239	2	FITTING, HOSE BARB 90° BRASS, 3/8 HOSE X 3/8 NPT	
46	42148	2	CLAMP, HOSE WORM GEAR 1/4 TO 5/8	
47	42192	55 IN	HOSE, 3/8 (RADIATOR TO SURGE TANK)	
48	40092	1	PIPE PLUG, 3/8 NPT	
49	60824	1	SENSOR FLUID LEVEL	
50	40811	61 IN	HOSE, OVERFLOW 5/16" ID	
51	41265	32 IN	HOSE, HEATER 1" X 32" LG - SURGE TANK TO FRAME	
52	40190-2	2	CLAMP, CONSTANT TORQUE 1 1/16 -2	
53	40721	1	FITTING, HOSE BARB 90° STEEL, 1" HOSE X 1" NPT	
54	40722	1	FITTING, HOSE BARB 45° STEEL, 1" HOSE X 1" NPT	
55	42110	1	FITTING, HOSE BARB STR STEEL, 1" HOSE X 1" NPT	
56	41265	26 IN	HOSE, HEATER 1" X 26" LG - FRAME TO WATER PUMP	
57	40190-2	2	CLAMP, CONSTANT TORQUE 1 1/16 -2	
58	12898	1	FRAME COUPLING BRACKET, SURGE TANK	
59	82394	2	BOLT, HEX 3/8"-16 X 1 1/2" Lg	
60	85091	4	WASHER, FLAT 3/8"	
61	85025	2	NUT, 3/8"-16 NYLON	
REV	DATE	BY		SHEET
A	1/27/2018	MAL		2 OF 3

