

FRONT ENGINE MOUNT

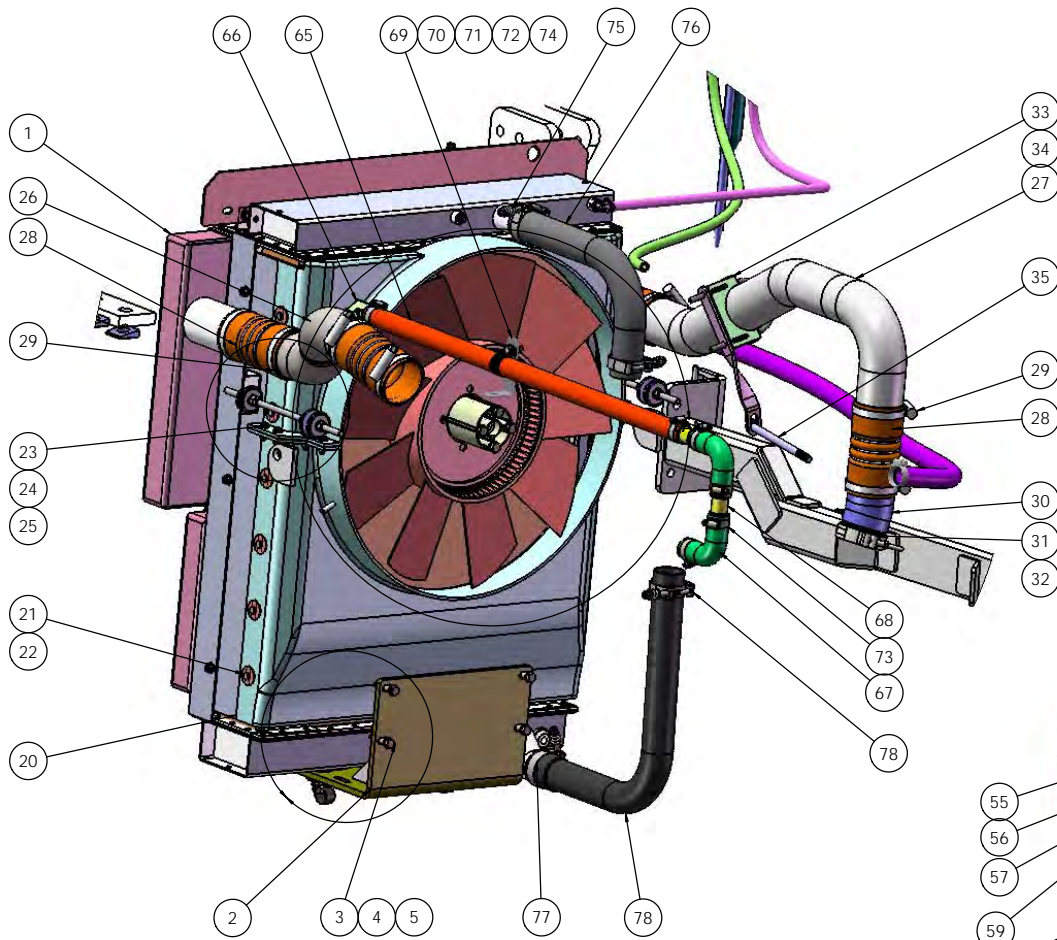

RADIATOR ASSEMBLY

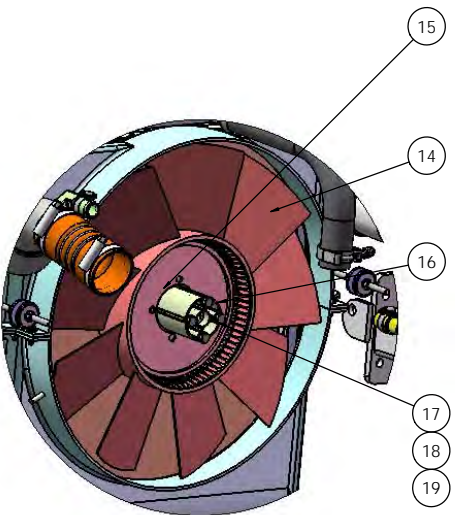

FAN DETAIL

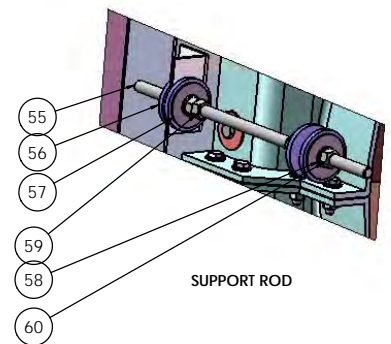

SUPPORT ROD

REFERENCES ARE IN INCHES	ISSUE	DATE	 <small>WECO TERMINAL SERVICE 44 CYPRUS ROAD DR. ROCKLAND, NC 27854 (843) 717-2226</small>
<small> DIMENSIONS ARE IN INCHES UNLESS OTHERWISE SPECIFIED DECIMALS ARE TO 0.005 FRACTIONS ARE TO 1/16" </small>	<small> DESIGNED BY CHECKED BY APPROVED BY </small>	<small> 1/13/2017 </small>	
<small> DIMENSIONS ARE IN INCHES UNLESS OTHERWISE SPECIFIED DECIMALS ARE TO 0.005 FRACTIONS ARE TO 1/16" </small>	<small> THE DRAWING PARTS SHOWN AND DESCRIBED IN THE DRAWING ARE THE PROPERTY OF WECO TERMINAL SERVICE AND SHALL REMAIN THE PROPERTY OF WECO TERMINAL SERVICE. NO PARTS OR INFORMATION FROM THIS DRAWING SHALL BE REPRODUCED OR TRANSMITTED IN ANY FORM OR BY ANY MEANS, ELECTRONIC, MECHANICAL, PHOTOCOPYING, RECORDING, OR BY ANY INFORMATION STORAGE AND RETRIEVAL SYSTEM, WITHOUT THE WRITTEN PERMISSION OF WECO TERMINAL SERVICE. </small>	<small> SIZE: D DWG. NO: 721601-A1 SCALE: 1:32 WEIGHT: 6009 </small>	<small> REV: 1 SHEET 2 OF 3 </small>

TICO PRO-SPOTTER			
COOLING SYSTEM, 2015/2016-ISB, QSB-IV			721601
ITEM	PART #	QTY/M	DESCRIPTION
	721601-A1	REF	COOLING SYSTEM, QSB-IV
1	620586	1	RADIATOR ASSY - W/AC CONDENSER MTG - 1/2" STUDS,BAR/PLATE
2	12736	1	RADIATOR MOUNT, RUBBER ISOLATORS
3	82405	4	BOLT, HEX 3/8-16 x 1-3/4" Lg BRKT to ENGINE MT
4	85036	4	LOCKNUT - 3/8-16
5	85091	8	WASHER, FLAT 3/8
6	62254	2	ISOLATOR - RADIATOR MOUNT
7	85025	2	LOCKNUT, 3/8-16
8	85091	2	WASHER, FLAT 3/8
9	85014	2	NUT, HEX 3/8-16
10	40593	2	CLAMP, P 1.0
11	80346	4	WASHER, FENDER 3/8" ID x 1 1/2" OD
12	62110	2	WASHER - FRONT ENGINE MOUNT - BOTTOM
13	62332	2	WASHER - RADIATOR MOUNT TOP
14	61647	1	FAN,ENG 22" 9 BLADE COMP 3.75 PW
15	62328	1	PLATE, FAN CAPTURE
16	62173-2	1	FAN SPACER-3"LG FURN W/ENGINE
17	80237	4	BOLT, HEX M10 X 1.5 X 100MM LG (FAN TO ENG)
18	85135	4	LOCKWASHER 3/8
19	85091	4	FLATWASHER 3/8
20	60988	1	FAN SHROUD
21	82359	12	BOLT, HEX 1/4-20 X 3/4" LG SHROUD SIDES
22	80129	12	WASHER, FENDER 1/4" ID x 1 1/4" OD
23	85034	12	LOCKNUT 1/4
24	82370	8	BOLT, HEX 1/4-20 X 1" LG
25	85111	16	WASHER, FLAT 1/4
NOT SHOWN	40593	2	P-CLAMP
26	62055	1	TUBE, CAC LH
27	61968	1	TUBE, CAC RH
28	40175	4	HOSE, HUMP
29	40185	8	CLAMP, CONSTANT TORQUE 2 3/4 - 3 5/8
30	62048	1	ELBOW, CAC PIPE, ISB
31	42261	1	CLAMP, V BAND
32	42262	1	SEAL, O-RING
REV	DATE	BY	SHEET
A	7/27/2017	MAL	1 OF 3

TICO PRO-SPOTTER				
COOLING SYSTEM, 2015/2016-ISB, QSB-IV				721601
ITEM	PART #	QTY/M	DESCRIPTION	
33	30337	1	BRACKET, CAC RH TUBE TO ALTERNATOR	
34	40005	1	CLAMP, 3" MUFFLER	
35	80368	1	BOLT, HEX HD 12mm X 160mm LG GRD 8.8 PLATED	
36	61936	1	SURGE TANK	
37	82407	4	BOLT-1/2-13NC X 1 3/4 LG HEX HD	
38	85115	4	WASHER, FLAT 1/2	
39	85027	4	LOCKNUT, 1/2-13 NYLON	
40	42239	4	FITTING, HOSE BARB 90° BRASS, 3/8 HOSE X 3/8 NPT	
41	42148	4	CLAMP, HOSE WORM GEAR 1/4 TO 5/8	
42	41158	65 IN	HOSE, 3/8 (ENGINE TO SURGE TANK)	
43	41158	55 IN	HOSE, 3/8 (RADIATOR TO SURGE TANK)	
44	40092	1	PIPE PLUG, 3/8 NPT	
45	60824	1	SENSOR FLUID LEVEL	
46	40811	61 IN	HOSE, OVERFLOW 5/16" ID	
47	41014	1	HOSE, HEATER 1" X 32" LG - SURGE TANK TO FRAME	
48	40190-2	4	CLAMP, CONSTANT TORQUE 1 1/16 -2	
49	40722	1	FITTING, HOSE BARB 90° STEEL, 1" HOSE X 1" NPT	
50	40721	1	FITTING, HOSE BARB 45° STEEL, 1" HOSE X 1" NPT	
51	42110	1	FITTING, HOSE BARB STR STEEL, 1" HOSE X 1" NPT	
52	41015	1	HOSE, HEATER 1" X 26" LG - FRAME TO WATER PUMP	
54	61644	1	BAFFLE - RADIATOR TOP	
55	61603	2	ROD, THREADED 3/8-16 x 12" LG	
56	60857	8	RUBBER MOUNT, 3/8 ID x 1.75 OD	
57	80346	8	WASHER, FENDER 3/8" ID x 1.75 OD	
58	85102	8	WASHER, FLAT 3/8	
59	85003	4	JAM NUT, 3/8-16	
60	85036	4	NUT, LOCK 3/8	
61	12898	1	FRAME COUPLING BRACKET, SURGE TANK	
62	82394	2	BOLT, HEX 3/8"-16 X 1 1/2" Lg	
63	85091	4	WASHER, FLAT 3/8"	
64	85025	2	NUT, 3/8"-16 NYLON	
REV	DATE	BY		SHEET
A	7/27/2017	MAL		2 OF 3

TICO MANUFACTURING - RIDGELAND, SC 29936

