

**A: FRONT MOUNTS  
PAGE 2**

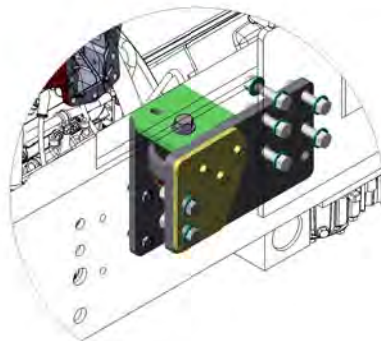

**B: REAR MOUNTS  
PAGE 2**

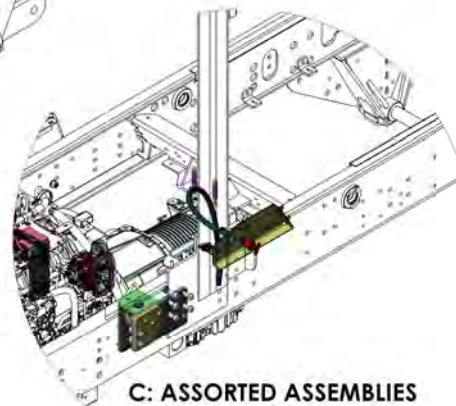
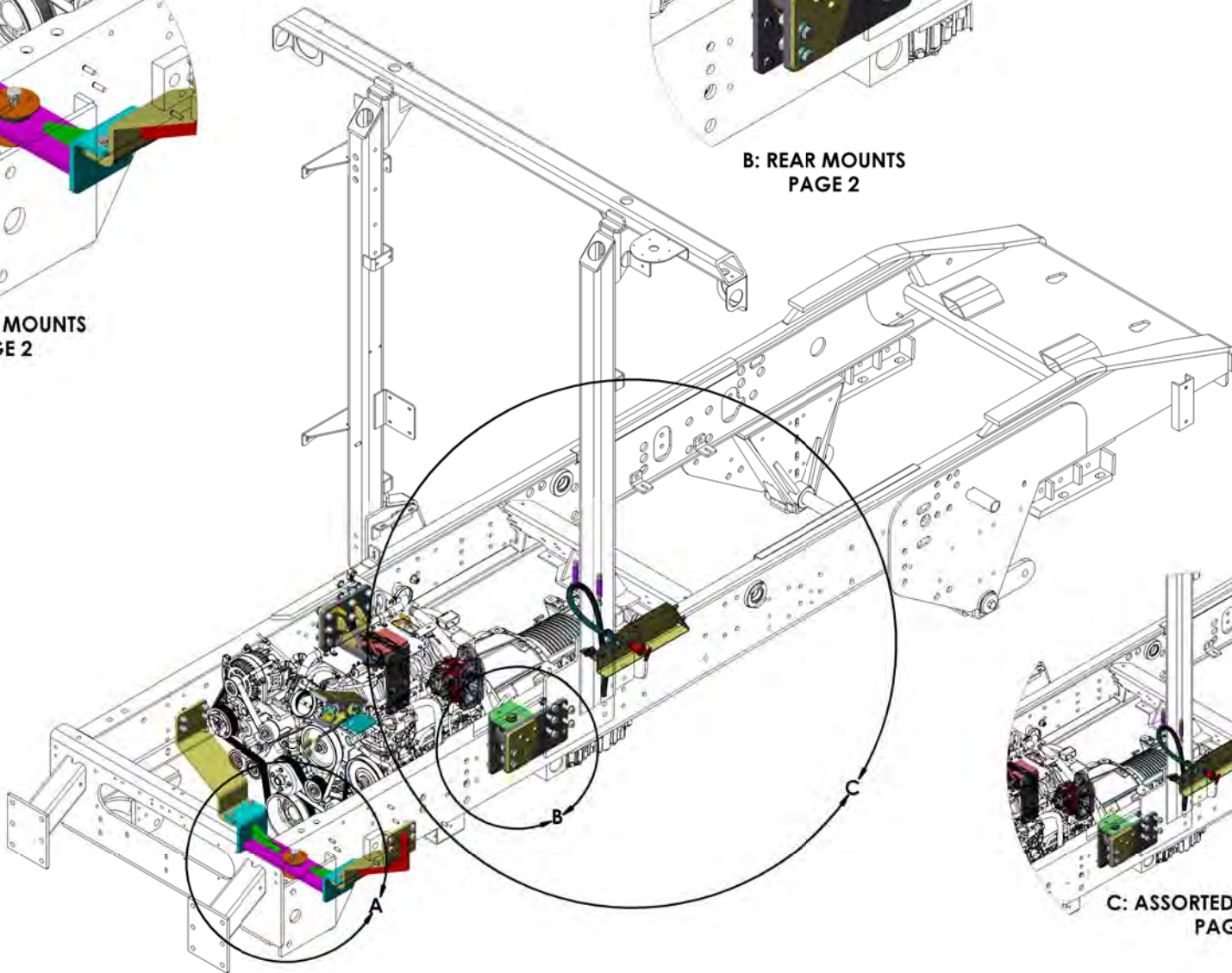

**C: ASSORTED ASSEMBLIES  
PAGE 3**

DIMENSIONS ARE IN INCHES TOLERANCES: DECIMAL		NAME	DATE	 TICG/TERMINAL SERVICE 86 CYPRESS RIDGE DR. RIDGELAND, SC 29936 (843) 717-2226
H.H.    0.06 K.K.    0.03 M.M.    0.015 N.N.    0.008 P.P.    0.004 Q.Q.    0.002	R.R.    0.0015 S.S.    0.0008 T.T.    0.0004 U.U.    0.0002	DRAWN	MAL	
PREPARE GEOMETRIC TOLERANCING PER: ASME Y14.5M-1994		CHECKED		
MATERIAL 1/1A		APPROVED		
FINISH SEE NOTE		DO NOT SCALE DRAWING		
TITLESHEET T/1A		THE SUBJECT MATTER SHOWN AND DESCRIBED IN THIS DRAWING AND ANY OTHER INFORMATION ADVANCED IN CONNECTION THEREWITH IS PROPRIETARY PROPERTY AND IS TO BE HELD IN STRICT CONFIDENCE BY YOU. ALL RIGHTS TO ANY INVENTIONS, DESIGN, TRADE MARKS, TRADE NAMES AND COPYRIGHT DECLARATIONS ARE RESERVED TO TICG/TERMINAL SERVICE, INC.		
		TITLE: ENGINE & TRANSMISSION, PSI 8.8L CNG		SIZE DWG. NO. <b>C</b> 721320-E1
		SCALE: 1:48   WEIGHT: 3821.28   SHEET 1 OF 1		REV

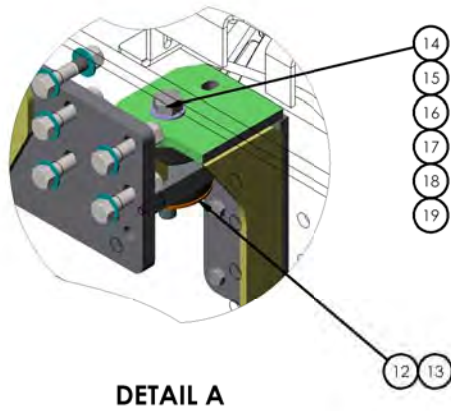

DETAIL A

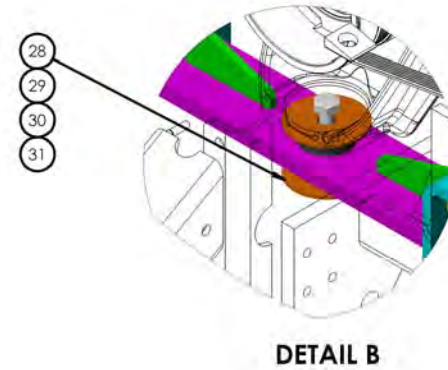

DETAIL B

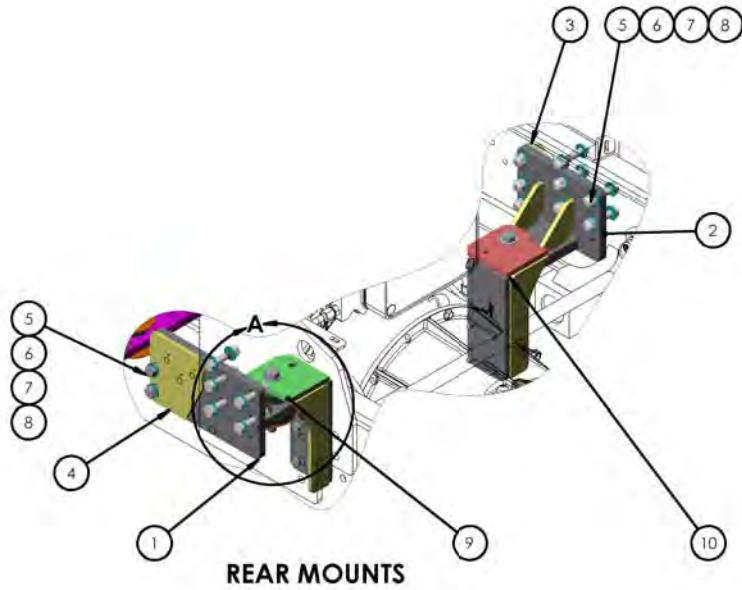

REAR MOUNTS

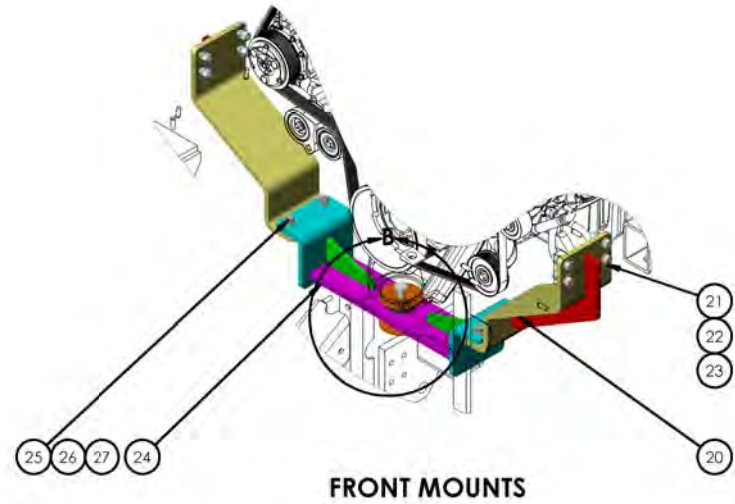

FRONT MOUNTS

DIMENSIONS ARE IN INCHES		NAME	DATE	 TICO/TERMINAL SERVICE 66 CYPRESS RIDGE DR. RIDGELAND, SC 29936 (843) 717-2226	
TOLERANCES:		DRAWN	MAL		02/07/2017
DECIMAL:		CHECKED			
.XX    ■ 0.06 .XXX   ■ 0.03 .XXXX   ■ 0.005 ANGULAR:   ■ 0.5° FRACTIONAL:   ■ 1/32"		APPROVED			
INTERPRET GEOMETRIC TOLERANCING PER: ASME Y14.5M-1994		DO NOT SCALE DRAWING			TITLE: ENGINE & TRANSMISSION, PSI 8.8L CNG
MATERIAL	N/A	THE SUBJECT MATTER SHOWN AND DESCRIBED IN THIS DRAWING AND ANY OTHER INFORMATION ADVANCED IN CONNECTION THEREWITH IS PROPRIETARY PROPERTY AND IS TO BE HELD IN STRICT CONFIDENCE BY YOU. ALL RIGHTS TO ANY INVENTIONS, DESIGN, TRADE MARKS, TRADE NAMES AND COPYRIGHTS DECLARED ARE RESERVED TO TICO TERMINAL SERVICES, INC.		SIZE DWG. NO. REV	
FINISH	SEE NOTE			C 721320-E1	
THICKNESS	N/A			SCALE: 1:48   WEIGHT: 3821.28   SHEET 1 OF 1	

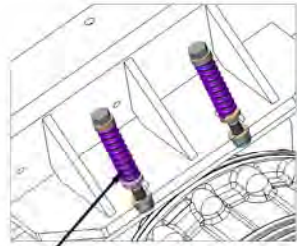

33 34 35 36

**VIBRATION DAMPENING SPRINGS**

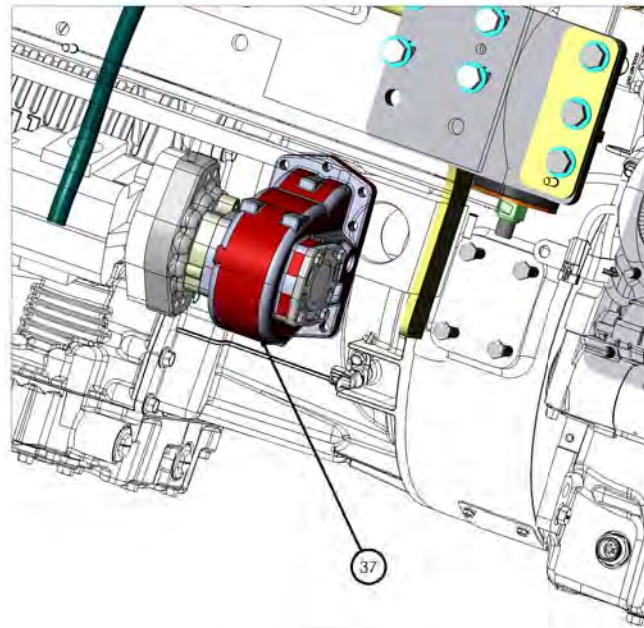

37

**PTO**

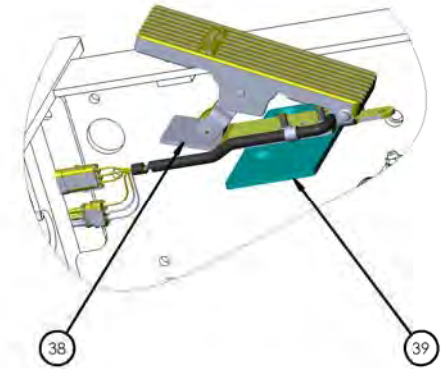

38

39

**PEDAL ASSEMBLY**

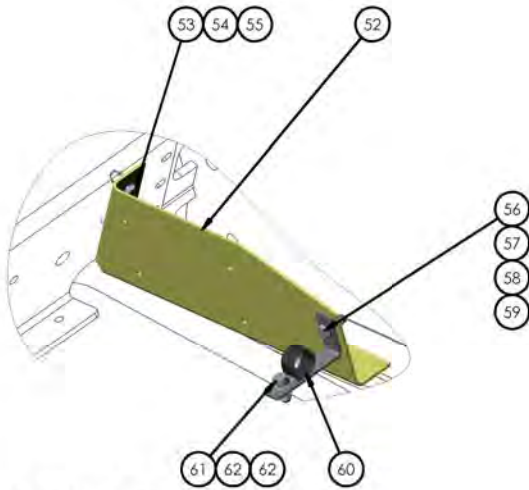

**ECM BRACKET**

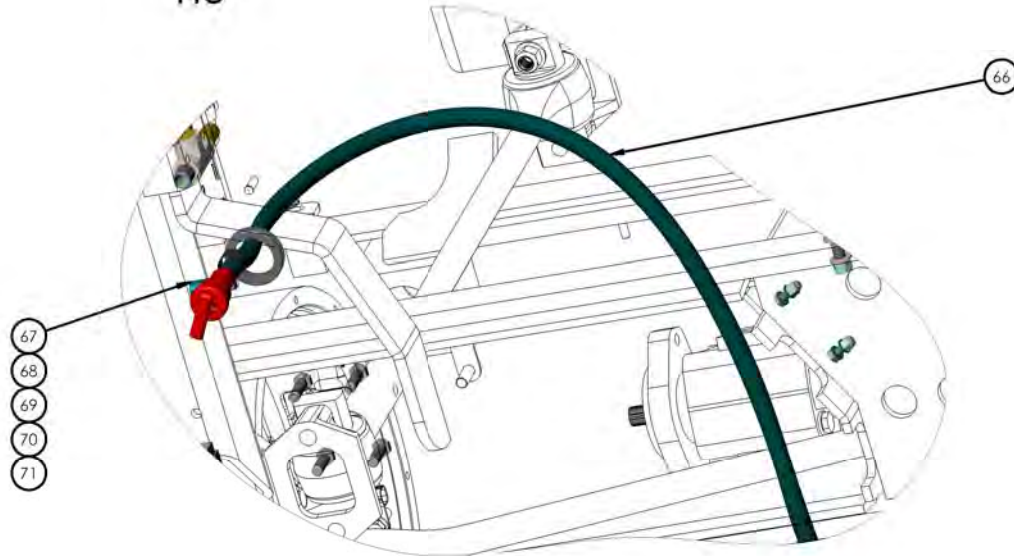

**DIPSTICK ASSEMBLY**

DIMENSIONS ARE IN INCHES		NAME	DATE	 TICO/TERMINAL SERVICE 86 CYPRESS RIDGE DR. RIDGELAND, SC 29936 (843) 717-2226
TOLERANCES:		DRAWN	MAL 02/07/2017	
DECIMAL:		CHECKED		
FRACTIONAL:		APPROVED		
PREPARE GEOMETRIC TOLERANCING PER: ASME Y14.5M-1994		DO NOT SCALE DRAWING		TITLE: <b>ENGINE &amp; TRANSMISSION, PSI          8.8L CNG</b>
MATERIAL: 11/A		THE SUBJECT MATTER SHOWN AND DESCRIBED IN THIS DRAWING AND ANY OTHER INFORMATION ADVANCED IN CONNECTION THEREWITH, IS PROPRIETARY PROPERTY AND IS TO BE HELD IN STRICT CONFIDENCE BY YOU. ALL RIGHTS TO ANY INVENTION, DESIGN, TRADE MARK, TRADE NAME AND COPYRIGHTS DECLARED ARE RESERVED TO TICO/TERMINAL SERVICE, INC.		SIZE DWG. NO. REV <b>C 721320-E1</b>
FINISH: SEE NOTE		SCALE: 1:48   WEIGHT: 3821.28   SHEET 1 OF 1		
FINISH: T/A				

TICO PRO-SPOTTER			
ENGINE & TRANSMISSION PSI 8,8L CNG			721320
ITEM	PART #	QTY/M	DESCRIPTION
	721320-E1	REF	ENGINE & TRANSMISSION PSI 8,8L CNG
	62375-1	REF	WIRE SCHEMATIC-TRANSMISSION, GEN-V
NOT SHOWN	620677	REF	ENGINE,PSI-8.8L, NA CNG ENGINE
NOT SHOWN	620513	REF	TRANSMISSION-ALLISON RDS 3000 SERIES TC-413
NOT SHOWN	62249	REF	TCM, GEN-V, 1ST-4TH, RDS-3000, 2400 SHIFT, PSI-8.8L LPG
NOT SHOWN	62192	REF	SHIFTER-TRANSMISSION, PUSH BUTTON, GEN V
1	121066	1	MOUNT, LP REAR ENGINE LH
2	121065	1	MOUNT, LP REAR ENGINE RH
3	121069	1	SPACER, LP REAR ENGINE MOUNT RH
4	121070	1	SPACER, LP REAR ENGINE MOUNT LH
5	82441	5	BOLT, HEX, 5/8-11 X 2-1/2 LG
6	82463	10	BOLT, HEX, 5/8-11 X 3 LG
7	85094	30	WASHER, FLAT, 5/8
8	85028	15	LOCKNUT, NYLOCK, 5/8-11
9	121163	1	MOUNT, LH REAR ENGINE SIDE MOUNT PSI 8.8L
10	121164	1	MOUNT, RH REAR ENGINE SIDE MOUNT PSI 8.8L
11	80240	8	BOLT-M12 x 1.5 x 35mm, HEX HD, 10.9 <i>(APPLY LOCKTITE &amp; TORQUE BOLTS TO 40 FT-LB)</i>
12	620704	2	ISOLATOR, REAR ENGINE, PSI 8.8L
13	61677-8	2	SPACER-BOLT
14	60740	2	WASHER-3/4, REAR ENGINE MOUNT
15	85095	2	WASHER, FLAT, 3/4
16	60740-1	2	WASHER, 3/4, REAR ENGINE MOUNT
17	82552	1	BOLT, HEX, 3/4-10 X 5 LG
18	82574	2	BOLT, HEX, 3/4-10 X 5-1/2 LG
19	85029	2	LOCKNUT, NYLOCK, 3/4-10
20	121074	2	MOUNT, LP FRONT ENGINE FRAME BRKT
21	82407	8	BOLT, HEX, 1/2-13 X 1-3/4 LG
22	85093	16	WASHER, FLAT, 1/2
23	85027	8	LOCKNUT, NYLOCK, 1/2-13
24	121071	1	MOUNT, LP FRONT CROSSMEMBER BRKT
25	82418	4	BOLT, HEX, 1/2-13 X 2 LG
26	85093	8	WASHER, FLAT, 1/2
27	85027	4	LOCKNUT, NYLOCK, 1/2-13
<b>REV</b>	<b>DATE</b>	<b>BY</b>	<b>SHEET</b>
E	02/07/2017	MAL	1 OF 3

TICO PRO-SPOTTER				
ENGINE & TRANSMISSION PSI 8,8L CNG				721320
ITEM	PART #	QTY/M	DESCRIPTION	
28	620705	1	ISOLATOR, FRONT ENGINE, PSI 8.8L	
29	60740-1	2	SPACER, REAR MOTOR MOUNT 13/16IDX3.75OD X 10GA THK	
30	82529	1	BOLT, 5/8-11 X 4-1/2" LG	
31	85028	1	LOCKNUT, NYLOCK, 5/8-11	
32	10971	1	SPACER FRONT MOTOR MOUNT QSB-III/ISB-07	
33	40448	2	SPRING, COMPRESSION MUD FLAP MOUNT 430#/INCH	
34	82550	2	BOLT, HEX 1/2-13 X 5 LG	
35	85093	6	WASHER, FLAT, 1/2	
36	85027	2	LOCKNUT, NYLOCK, 1/2-13	
37	61789	1	PTO-HYD-CONSTANT MESH-WET SPLINE-3000RDS-0.87:1 RATIO	
NOT SHOWN	60943	REF	PUMP-HYD, 16 GPM @ 2100 RPM, CW	
NOT SHOWN	41037	1	HOSE TRANS TO PTO	
38	61640	1	PEDAL ACCELERATOR - ELECTRONIC ISB	
39	90632	1	MOUNTING PLATE ELECTRIC THROTTLE	
NOT SHOWN	83318	1	SC HC SCREW 3/8-16 x 3 1/2" Lg	
NOT SHOWN	85113	2	WASHER, FLAT 3/8	
NOT SHOWN	85036	2	LOCKNUT, 3/8-16	
40	85090	2	WASHER, FLAT 5/16	
41	85035	2	LOCKNUT 5/16	
42	83340	1	SC HC SCREW 3/8-16 x 4" Lg	
NOT SHOWN	620532	1	ADAPTATION KIT-PSI 8.8/RDS3000 CRANKSHAFT ADAPTER	
NOT SHOWN	620533	1	ADAPTATION KIT-PSI 8.8/RDS3000 ADAPTER & FLEXPLATES	
NOT SHOWN	800446	6	BOLT-PSI CRANKSHAFT, 12PT-7/16-20UNF	
NOT SHOWN	60799-11	12	BOLT-RING GEAR & FLEXPLATES	
NOT SHOWN	60799-12	1	BOLT & WASHER KIT- TRANSMISSION MOUNTING	
NOT SHOWN	40467	1	FITTING, TEE, STREET, 1/8" NPT	
NOT SHOWN	60956	2	BRACKET TRANS COOLING LINE	
NOT SHOWN	41240	1	HOSE ASSY, #12 X 93" LG, TRANS to COOLER	
NOT SHOWN	41026	1	HOSE, ASSY, #12X 86" LG, TRANS to COOLER	
NOT SHOWN	40471	2	FITTING, ADAPTER STR, 3/4 O-RING X # 12 JIC	
NOT SHOWN	10624	2	FITTING, ADAPTER 90°, 3/4 O-RING X # 12 JIC	
NOT SHOWN	620616	1	HARNESS-WIRE, 2016 PSI ENGINE, CNG, GASOLINE, LP	
NOT SHOWN	620698	1	HARNESS- FUEL SYSTEM, PSI, CNG,AGILITY, SINGLE TANK,LH FMM, FUSED PWR	
NOT SHOWN	620711	1	HARNESS-WIRE, PSI ENGINES, MAF EXTENSION, 24"	
REV	DATE	BY		SHEET
E	02/07/2017	MAL		2 OF 3



SPANNING WIRE REGULATION TO BE USED FOR ALL SPANNING WIRE CONNECTIONS TO BE MADE TO THE FOLLOWING: ALUMINUM CONNECTORS, ALUMINUM TERMINALS, ETC. TYPICAL SHALL BE USED UNLESS OTHERWISE SPECIFIED. SPACERS IN HARNESS SHALL BE ULTRASONIC WELDS.

WIRE WVEST CABLE	CIRCUIT 1	CIRCUIT 2	CIRCUIT 3
1	TR-120	TR-180	
2	TR-139	TR-159	
3	TR-140	TR-160	
4	J1597-A	J1597-B	
5	J1839-A	J1839-B	
6	J1839-C	J1839-D	
7	J1839-C	J1839-D	

TRANSMISSION CONTROL MODULE	C1	C2	C3	C4	C5	C6	C7	C8
1	TR-120	TR-180						
2	TR-139	TR-159						
3	TR-140	TR-160						
4	J1597-A	J1597-B						
5	J1839-A	J1839-B						
6	J1839-C	J1839-D						
7	J1839-C	J1839-D						
8	J1839-C	J1839-D						
9	J1839-C	J1839-D						
10	J1839-C	J1839-D						
11	J1839-C	J1839-D						
12	J1839-C	J1839-D						
13	J1839-C	J1839-D						
14	J1839-C	J1839-D						
15	J1839-C	J1839-D						
16	J1839-C	J1839-D						
17	J1839-C	J1839-D						
18	J1839-C	J1839-D						
19	J1839-C	J1839-D						
20	J1839-C	J1839-D						

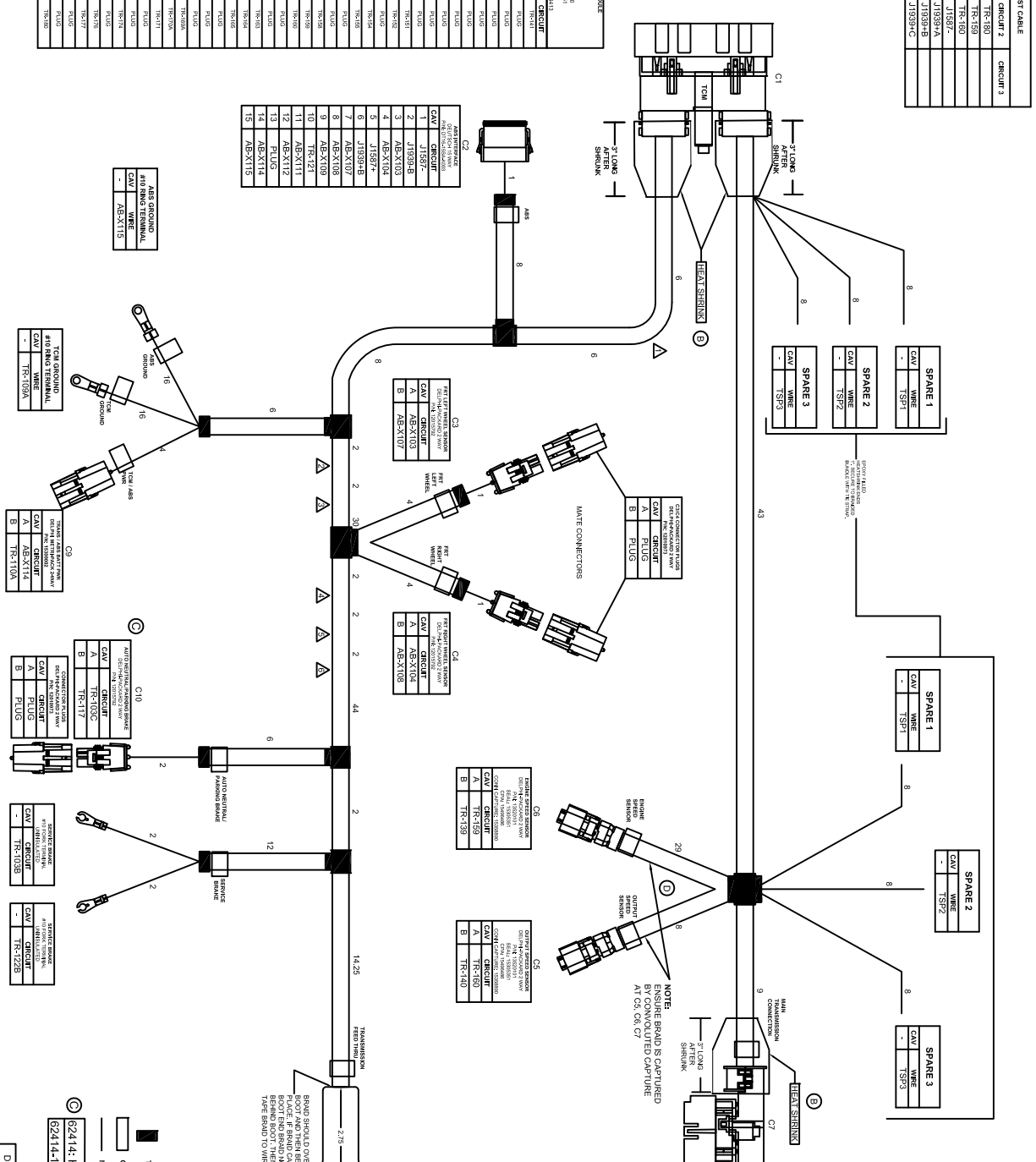

MAIN TRANSMISSION	C7	C8
1	TR-111	TR-111
2	TR-155	TR-155
3	TR-177	TR-177
4	TR-156	TR-156
5	TR-152	TR-152
6	TR-171	TR-171
7	TR-176	TR-176
8	TR-176	TR-176
9	TR-151	TR-151
10	TR-151	TR-151
11	TR-157	TR-157
12	TR-157	TR-157
13	TR-150	TR-150
14	TR-150	TR-150
15	TR-116	TR-116
16	TR-112	TR-112
17	TR-118	TR-118
18	TR-154	TR-154
19	TR-158	TR-158
20	TR-116	TR-116

TRANSMISSION CONTROL MODULE	C1	C2	C3	C4	C5	C6	C7	C8
1	TR-120	TR-180						
2	TR-139	TR-159						
3	TR-140	TR-160						
4	J1597-A	J1597-B						
5	J1839-A	J1839-B						
6	J1839-C	J1839-D						
7	J1839-C	J1839-D						
8	J1839-C	J1839-D						
9	J1839-C	J1839-D						
10	J1839-C	J1839-D						
11	J1839-C	J1839-D						
12	J1839-C	J1839-D						
13	J1839-C	J1839-D						
14	J1839-C	J1839-D						
15	J1839-C	J1839-D						
16	J1839-C	J1839-D						
17	J1839-C	J1839-D						
18	J1839-C	J1839-D						
19	J1839-C	J1839-D						
20	J1839-C	J1839-D						

62414-1 HARNESS COVERING TO BE BRAID.  
 62414-1 HARNESS COVERING TO BE CONVOLUTED TUBING.

REV	DESCRIPTION	ECN	DATE	APP
A	RELEASE			
B	ADDED HEAT SHRINK			
C	ADDED HEAT SHRINK			
D	CORRECTED BREAKOUT DIMENSIONS.			

REV	DESCRIPTION	ECN	DATE	APP
A	RELEASE			
B	ADDED HEAT SHRINK			
C	ADDED HEAT SHRINK			
D	CORRECTED BREAKOUT DIMENSIONS.			

REV	DESCRIPTION	ECN	DATE	APP
A	RELEASE			
B	ADDED HEAT SHRINK			
C	ADDED HEAT SHRINK			
D	CORRECTED BREAKOUT DIMENSIONS.			



REV.	DESCRIPTION	ECN	DATE	APPROVED
A	RELEASE	14348	7-14-2014	X

GEN-V 3000 TRANSMISSION E.C.U.  
LOCATED ON CHASSIS FRAME  
ADJACENT TO TRANSMISSION

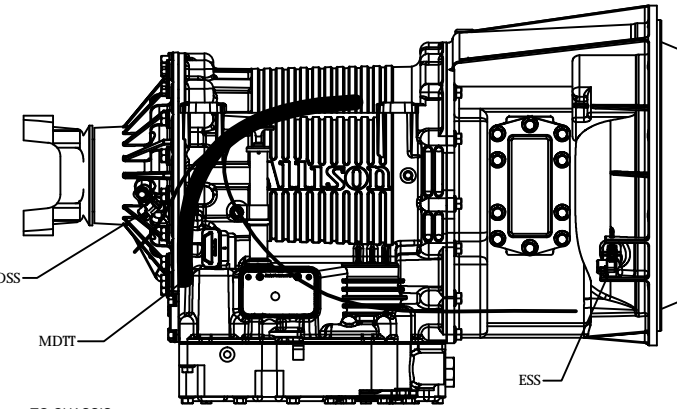
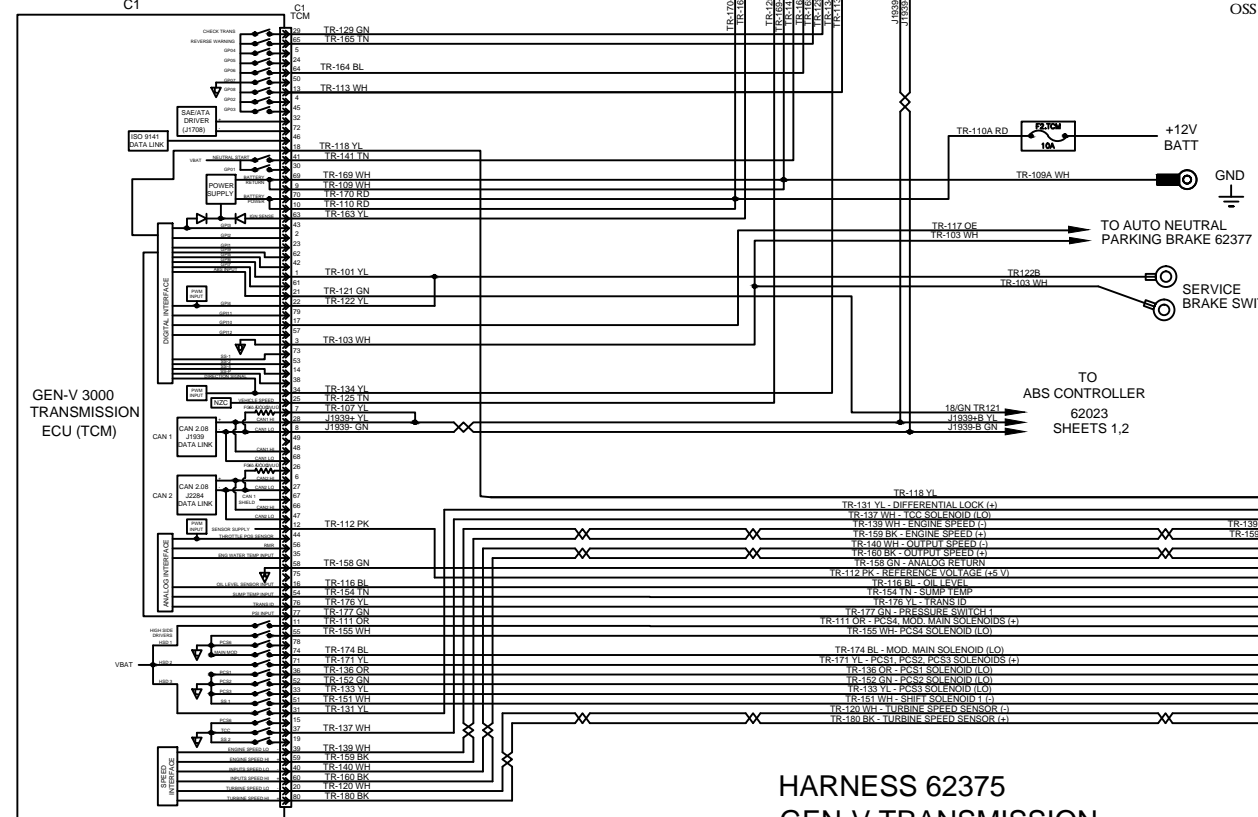

TO CHASSIS  
PDC SCHEMATIC  
62028  
SHEET 4/62028 SHEET 5 (QSB T4)

SERVICE  
BRAKE SWITCH

TO  
ABS CONTROLLER  
62023  
SHEETS 1,2

TRANSMISSION  
INTERFACE  
HARNESS

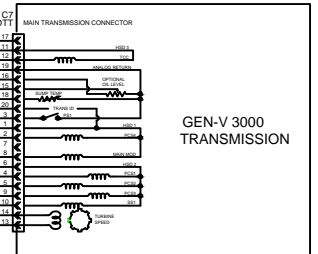

MDTT - Main Transmission Mating Connector

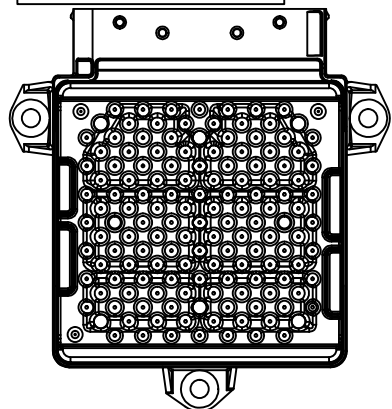

DIMENSIONS ARE IN INCHES TOLERANCES: DECIMAL: XX ± 0.06 XXX ± 0.03 XXX ± 0.05		NAME JK	DATE 7-14-2014	 TICO/TERMINAL 86 CYPRESS RIDGE RIDGELAND, SC 29127 (843) 717-2226
ANGULAR: FRACTIONAL: 1/32 1/16		CHECKED APPROVED		
INTERPRET GEOMETRIC TOLERANCING PER ASME Y14.5M-1994		DO NOT SCALE DRAWING		TITLE: SCHEMATIC - TRANSMISSION - GEN V, AUTO NEUTRAL V PARKING BRAKE SIZE C DWG. NO. 62375-1 R SCALE: 1:1 WEIGHT: 0.00 SHEET 1