

24 25 26 27  
2X

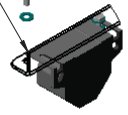

DETAIL A  
SCALE 1 : 4

2 1 4 5 6 7  
2X

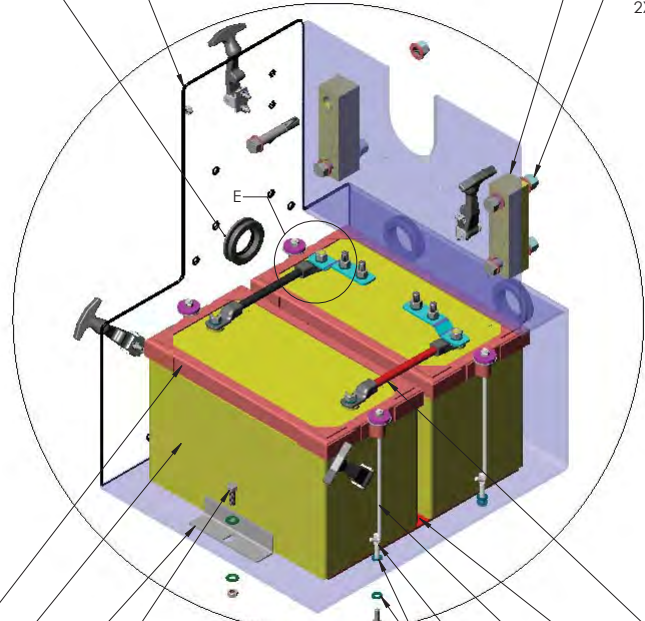

DETAIL B  
SCALE 1 : 5

32 33 34 35 36

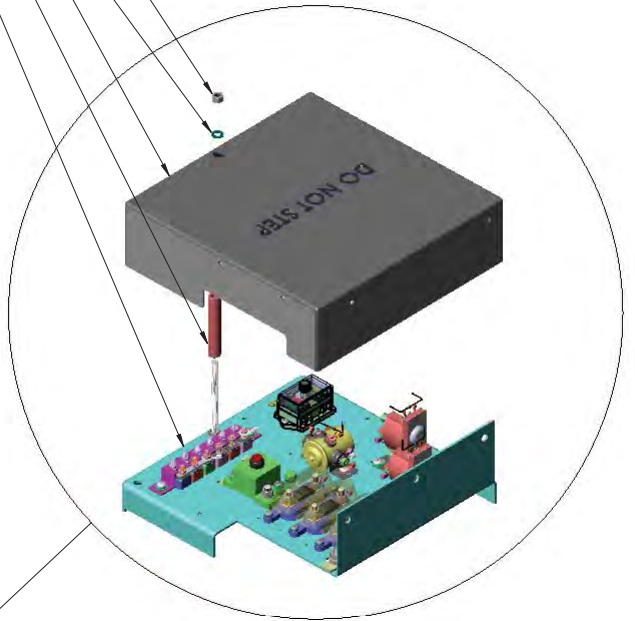

DETAIL C  
SCALE 1 : 5

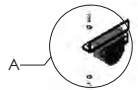

12 8 20 21 22 23  
2X

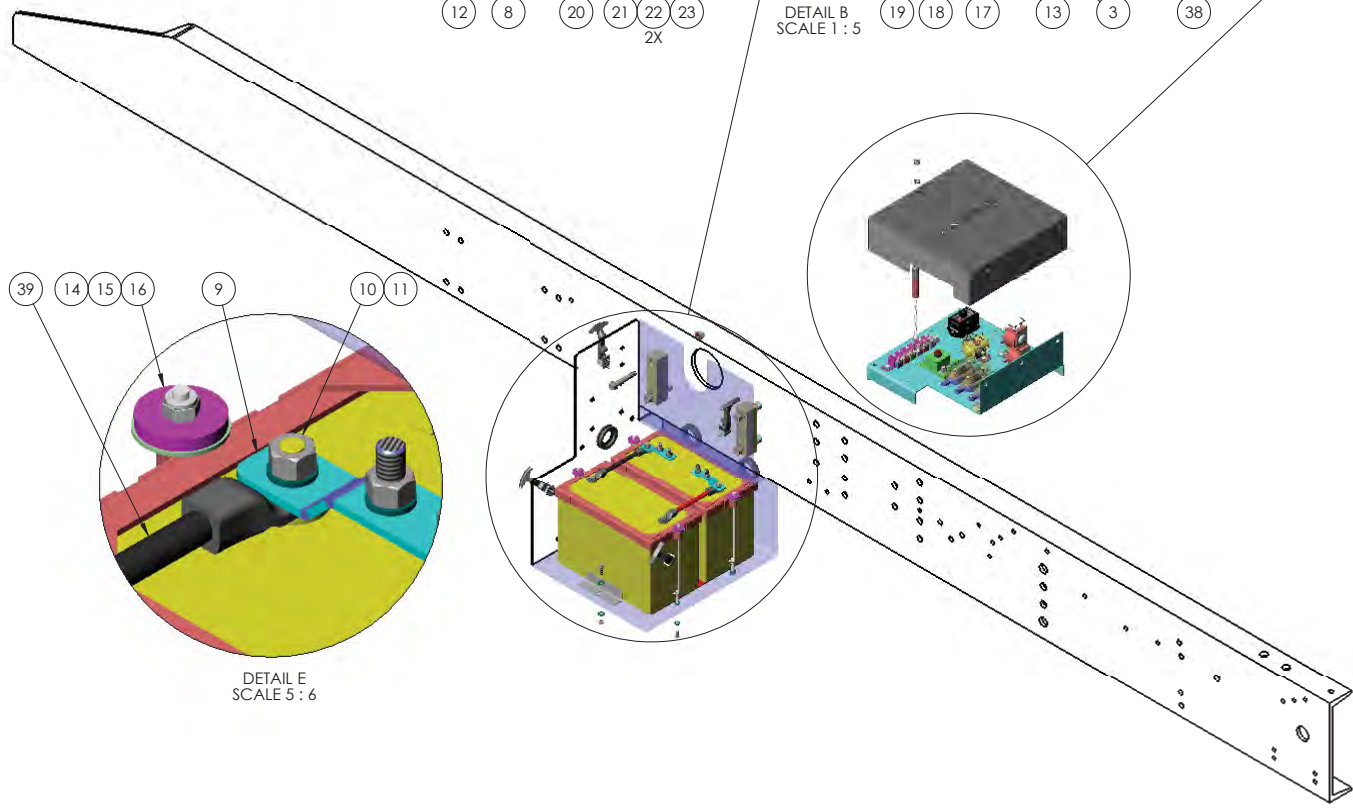

39 14 15 16 9 10 11

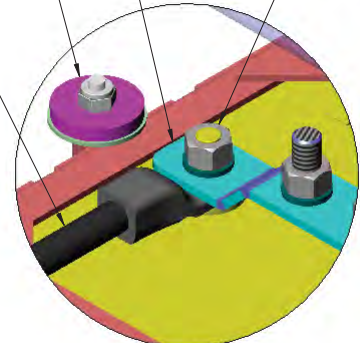

DETAIL E  
SCALE 5 : 6

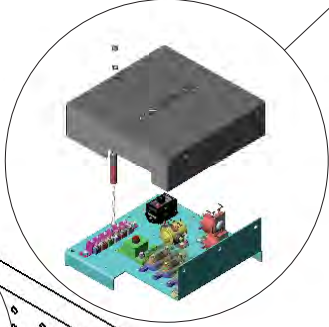

DETAIL D  
SCALE 1 : 2

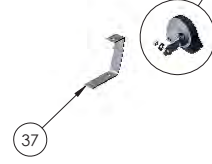

37

DIMENSIONS ARE IN INCHES		NAME	DATE
TOLERANCES:		DRAWN	DFM
DECIMAL:		REVISED	MPC
.XX ± 0.06		APPROVED	05/05/2016
.XXX ± 0.03		DO NOT SCALE DRAWING	
.XXXX ± 0.005		THE SUBJECT MATTER SHOWN AND DESCRIBED IN THIS DRAWING AND ANY OTHER INFORMATION ADVANCED IN CONNECTION THEREWITH IS PROPRIETARY PROPERTY AND IS TO BE HELD IN STRICT CONFIDENCE BY YOU. ALL RIGHTS TO ANY INVENTIONS, DESIGNS, TRADE MARKS, TRADE NAMES AND COPYRIGHTS DISCLOSED ARE RESERVED TO TICO TERMINAL SERVICES, INC.	
ANGULAR: ± 0.5°		TICO/TERMINAL SERVICE 66 CYPRESS RIDGE DR. RIDGELAND, SC 29936 (843) 717-2226	
FRACTIONAL: ± 1/32"		TITLE: ASSEMBLY, BATTERY & WIRING	
INTERPRET GEOMETRIC TOLERANCING PER: ASME 14.5M-1994		SIZE	DWG. NO.
MATERIAL		C	721050-A1
FINISH		REV	
THICKNESS		SHEET 1 OF 1	

TICO PRO-SPOTTER				
S/N:		ASSEMBLY, BATTERY & WIRING, QSB IV FINAL		721050
ITEM	PART #	QTY/M	DESCRIPTION	
	721050-A1	REF	ASSEMBLY, BATTERY & WIRING, QSB IV FINAL	
1	20319	1	ASSEMBLY, BATTERY BOX	
	20320	1	BASE, BATTERY BOX	
	20275	1	COVER, BATTERY BOX	
	20030-11	2	ASSEMBLY, LATCH, RUBBER	
	20030-18	2	HOLDER, LATCH, RUBBER	
	20030-17	2	LATCH, RUBBER	
	80196	4	BOLT, HEX HEAD, 10-32 X 1" LONG (HOLDER TO BATTERY BOX)	
	80232	4	WASHER, FLAT, #10	
	80209	4	LOCKNUT, 10-32	
NOT SHOWN	42292	1	COVER, RUBBER, BATTERY BOX	
2	90114	2	GROMMET	
3	40210-2	2	MAT, RUBBER	
4	20065-5	2	SPACER	
5	82485	4	BOLT, 5/8-11 X 3 1/2 LONG (BATTERY BOX TO FRAME)	
6	85094	8	WASHER, FLAT, 5/8-11	
7	85028	4	LOCKNUT, NYLON, 5/8-11	
8	91814	2	BATTERY, 31 SERIES, 730 CCA, 12 VOLT	
NOT SHOWN	42292	1	MAT, RUBBER	
9	90957	2	BUSS BAR, BATTERY	
10	85091	8	WASHER, FLAT, 3/8-16	
11	85025	8	LOCKNUT, HEX HEAD, 3/8-16	
12	20075	2	HOLD DOWN, BATTERY	
	20012	4	ASSEMBLY, J-BOLT	
13	20012-1	4	J-BOLT, 1/4-20 X 9 1/4 LONG (BATTERY HOLD DOWN)	
14	80129	4	WASHER, FENDER, 1/4-20 X 9 1/4 LONG	
15	20012-4	4	WASHER, PLASTIC, GRAY, .25 X 1.25 X .88	
16	85023	4	LOCKNUT, NYLON, 1/4-20	
NOT SHOWN	20012-4	2	WASHER, PLASTIC (BATTERY HOLD DOWN)	
17	20077	4	COUPLING, EYE, 1/4-20	
18	85111	8	WASHER, FLAT, 1/4-20	
19	82381	4	BOLT, HEX HEAD, 1/4-20 X 1 1/4 LONG	
20	12070	1	BRACKET, BATTERY STOP	
21	82371	1	BOLT, HEX HEAD, 5/16-18 X 1 LONG	
22	85090	2	WASHER, FLAT, 5/16-18	
23	85024	1	LOCKNUT, NYLON, 5/16-18	
REV	DATE	BY		SHEET
A	07/05/2016	MPC		1 OF 3



