

8 7 6 5 4 3 2 1

D
C
B
A

D
C
B
A

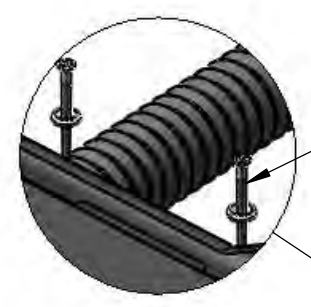

DETAIL A
SCALE 1 : 4

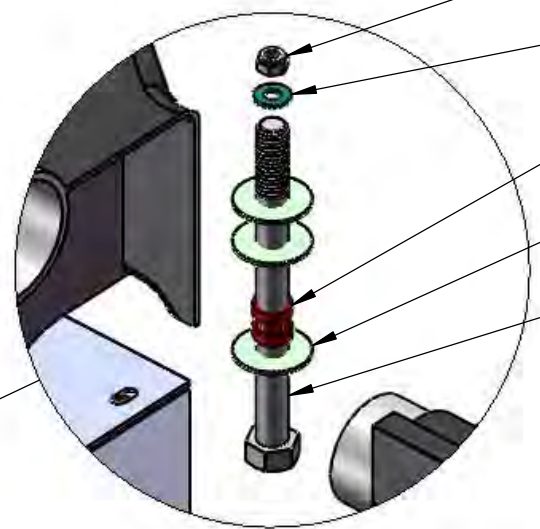

DETAIL B
SCALE 1 : 3

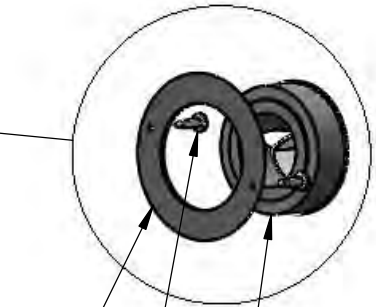

DETAIL C
SCALE 1 : 4

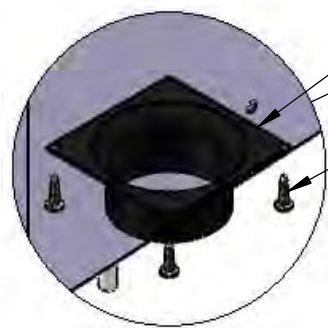

DETAIL E
SCALE 1 : 4

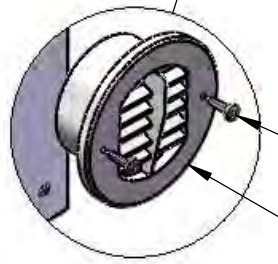

DETAIL D
SCALE 1 : 4

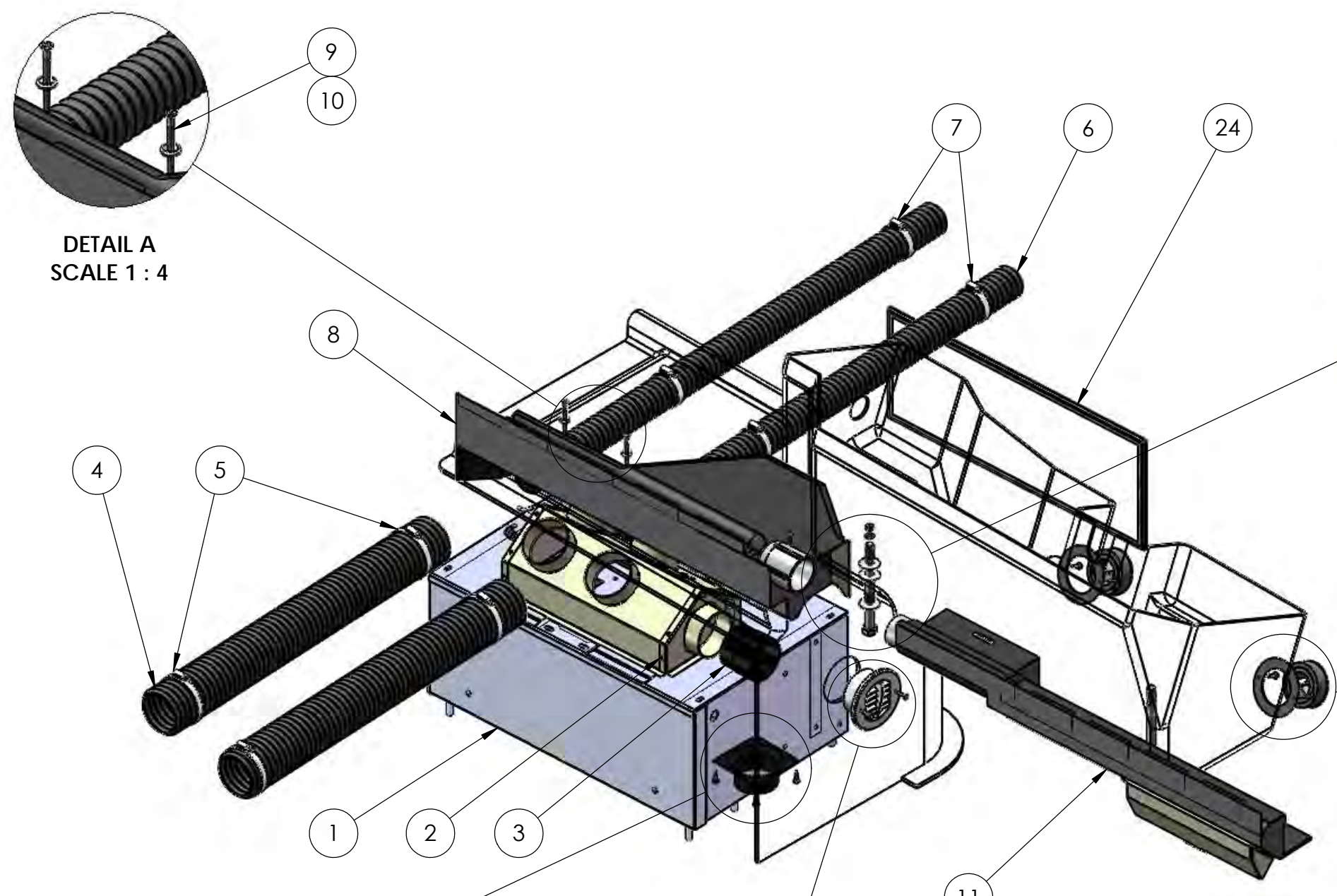

DIMENSIONS ARE IN INCHES TOLERANCES: DECIMAL: X.X ± 0.1250 X.XX ± 0.0625 X.XXX ± 0.0313 ANGULAR: ± 1° FRACTIONAL ± 1/16"	DRAWN SMB	NAME DATE 08/31/2015	TICO/TERMINAL SERVICE 66 CYPRESS RIDGE DR. RIDGELAND, SC 29936 (843) 717-2226
	REVISED MPC	07/05/2016	
	APPROVED		
	DO NOT SCALE DRAWING		
INTERPRET GEOMETRIC TOLERANCING PER: ASME 14.5M-1994	THE SUBJECT MATTER SHOWN AND DESCRIBED IN THIS DRAWING AND ANY OTHER INFORMATION ADVANCED IN CONNECTION THEREWITH, IS PROPRIETARY PROPERTY AND IS TO BE HELD IN STRICT CONFIDENCE BY YOU. ALL RIGHTS TO ANY INVENTIONS, DESIGNS, TRADE MARKS, TRADE NAMES AND COPYRIGHTS DISCLOSED ARE RESERVED TO TICO TERMINAL SERVICES, INC.		TITLE: ASSEMBLY, CAB HEATER QSB IVi
FINISH	SIZE B	DWG. NO. 720853-A1	REV
THICKNESS			SHEET 1 OF 1

8 7 6 5 4 3 2 1

TICO PRO-SPOTTER

S/N:	ASSEMBLY, HEATER	720853
-------------	-------------------------	---------------

ITEM	PART #	QTY/M	DESCRIPTION	
	720853-A1	REF	ASSEMBLY, HEATER	
1	91722-34	1	MODULE, HEATER	
NOT SHOWN	91921	1	MAT, HEATER	
2	91722-36	1	ASSEMBLY, PLENUM, CABLE CONTROLS	
3	91722-16	1	ADAPTER, HOSE, 3" TO 2-1/2"	
NOT SHOWN	91722-6	2 FT	HOSE, ULTRA SMOOTH, 2-1/2" ID	
NOT SHOWN	20337	2	CLAMP, WORMGEAR, LINER, 2-1/2" DIAMETER HOSE	
4	91722-26	2.88 FT	HOSE, FLEX, 3"	
	91722-26	1.75 FT	HOSE, FLEX, 3"	
	91722-26	1.00 FT	HOSE, FLEX, 3"	
5	42299	3	CLAMP, WORMGEAR, LINER, HOSE, 3" DIAMETER	
NOT SHOWN	42161	3	CLAMP, "T" BOLT, 3-1/4" TO 3-9/16"	
6	91722-4	6 FT	HOSE, FLEX, 2"	
	91722-4	5 FT	HOSE, FLEX, 2"	
7	42157	4	CLAMP, WORMGEAR, LINER, HOSE, 2" DIAMETER	
8	91783	1	DEFROSTER, MANIFOLD, LEFT-HAND	
9	800428	2	SCREW, FLAT HEAD, PHILLIPS, #12 X 2-1/2 LONG	
10	800431	2	WASHER, FINISHING, NICKEL PLATED, #12	
11	91828	1	DEFROSTER, MANIFOLD, RIGHT-HAND	
12	82392	2	BOLT, HEX HEAD, 1/4-20 X 1-1/2 LONG	
13	80129	6	WASHER, FENDER, 1/4-20 X 1-1/4 LONG	
14	80303	3	GROMMET, RUBBER, 1/2 X 5/8 X 5/16 HOLE	
15	85089	2	WASHER, FLAT, 1/4	
16	85023	2	LOCKNUT, NYLON, 1/4-20	
17	91722-13	2	LOUVER, 2-1/2" (NO ADAPTER BALL)	
NOT SHOWN	91722-14	2	ADAPTER, BALL LOUVER, HOSE, 2"	
18	91722-15	2	RING, LOUVER TRIM	
19	800429	2	SCREW, SHEET METAL, PAN HEAD, PHILLIPS, STAINLESS STEEL, #10 X 1/2 LONG	
20	91722-18	1	LOUVER, DOWNDRAFT, FIXED, 3"	
21	800430	4	SCREW, SHEET METAL, PAN HEAD, PHILLIPS, STAINLESS STEEL, #10 X 3/4 LONG	
22	91722-17	1	ADAPTER, HOSE, FLANGED, 3"	
23	800429	2	SCREW, SHEET METAL, PAN HEAD, PHILLIPS, STAINLESS STEEL, #10 X 1/2 LONG	
24	920011	1	FILTER, HEATER/AC, PERMATRON, 20-1/2 X 8	
REV	DATE	BY		SHEET
A	08/24/2016	MPC		1 OF 1

