

DETAIL A
SCALE 1 : 4

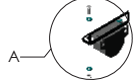

DETAIL B
SCALE 1 : 5

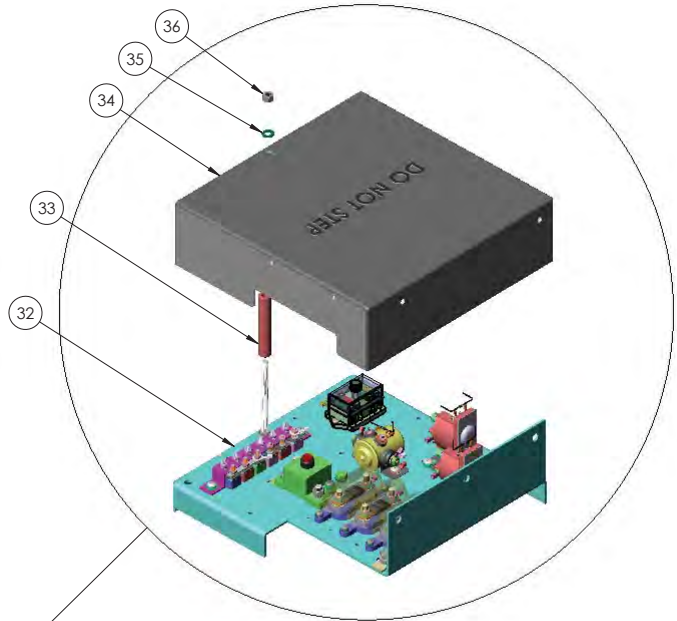

DETAIL C
SCALE 1 : 5



DETAIL D
SCALE 1 : 2

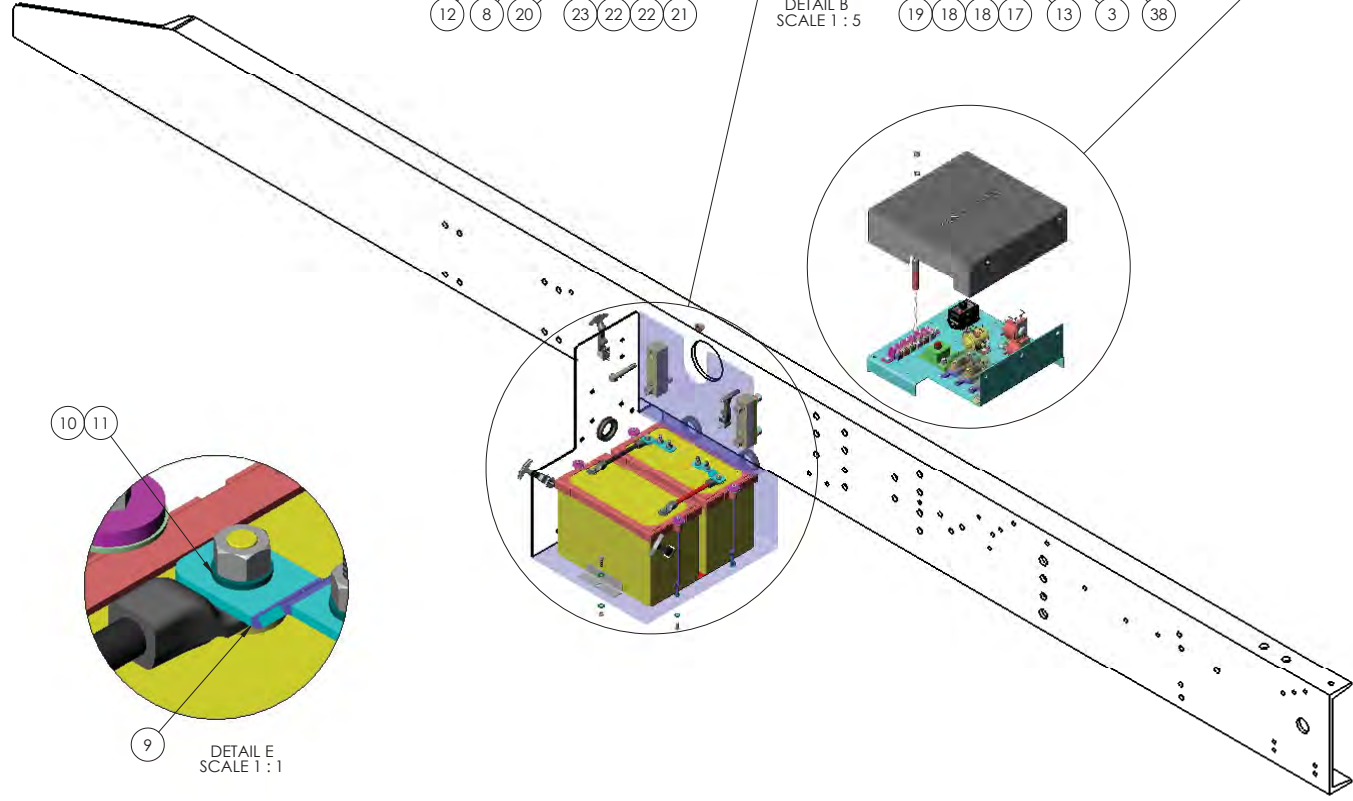

DETAIL E
SCALE 1 : 1

DIMENSIONS ARE IN INCHES

TOLERANCES:
 DECIMAL:
 XX ± 0.06
 XXX ± 0.03
 XXXX ± 0.005
 ANGULAR: ± 0.5°
 FRACTIONAL: ± 1/32"

INTERPRET GEOMETRIC TOLERANCING
 PER: ASME 14.5M-1994

MATERIAL:
 FINISH:
 THICKNESS:

| NAME | DATE |
|-------------|-----------|
| DRAWN SMB | 9/22/2015 |
| REVISED DFM | 2/3/2016 |
| APPROVED | |

DO NOT SCALE DRAWING

| | | |
|---|------------------------------|--|
| | | TICO/TERMINAL SERVICE 66 CYPRESS RIDGE DR. RIDGELAND, SC 29936 (843) 717-2226 |
| TITLE: BATTERY & WIRING, 2 BATTERIES | | |
| SIZE C | DWG. NO. 720799-C1 | REV 1 |
| SCALE: 1:12 | SHEET 1 OF 1 | |

THE SUBJECT MATTER SHOWN AND
 DESCRIBED IN THIS DRAWING AND ANY
 OTHER INFORMATION ADVANCED IN
 CONNECTION THEREWITH IS
 PROPRIETARY PROPERTY AND IS TO BE
 HELD IN STRICT CONFIDENCE BY YOU.
 ALL RIGHTS TO ANY INVENTIONS,
 DESIGNS, TRADE MARKS, TRADE
 NAMES AND COPYRIGHTS DISCLOSED
 ARE RESERVED TO TICO TERMINAL
 SERVICES, INC.

TICO PRO-SPOTTER

| | | |
|-------------|--|---------------|
| S/N: | BATTERY & WIRING - QSB3 IVi, ACC, 3 BATTERIES | 720799 |
|-------------|--|---------------|

| ITEM | PART # | QTY/M | DESCRIPTION | TASK |
|------------|-------------|-----------|--|--------------|
| | 71385-B1 | REF | BATTERY & WIRING - QSB3, RDS, 2 BATTERIES | |
| 1 | 62012 | 1 | ASSEMBLY, TRIPLE BATTERY BOX | |
| | 62004 | 1 | BASE, TRIPLE BATTERY BOX | |
| | 62003 | 1 | COVER, TRIPLE BATTERY BOX | |
| | 20030-17 | 4 | LATCH, RUBBER | |
| | 80196 | 8 | BOLT, HEX, 10-32 X 1" LONG (HOLDER to BATTERY BOX) | |
| | 80232 | 8 | WASHER, FLAT, #10 | |
| | 80209 | 8 | LOCKNUT, NUT, LOCK NYLON, 10-32, | |
| 2 | 90120 | 3 | GROMMET | |
| 3 | 40210-2 | 1 | MAT, RUBBER | |
| 4 | 20065-5 | 2 | SPACER | |
| 5 | 82485 | 4 | BOLT, 5/8"-11 X 3.5", LONG, (BATTERY BOX to FRAME) | |
| 6 | 85094 | 8 | WASHER, HARDENED, 5/8" | |
| 7 | 85028 | 4 | NUT, LOCK, NYLON, 5/8"-13 | |
| 8 | 91814 | 2 | BATTERY, 31 SERIES, 730 CCA, 12 VOLT | |
| NOT SHOWN | 42292 | 1 | MAT, RUBBER | |
| 9 | 90957 | 2 | BUSS BAR, BATTERY | |
| 10 | 85091 | 4 | WASHER, HARDENED, 3/8" | |
| 11 | 85024 | 1 | NUT, LOCK, NYLON, 3/8"-16 | |
| 12 | 20075 | 2 | HOLD DOWN RUBBER STRAP, BATTERY | |
| | 20012 | 4 | ASSEMBLY, J-BOLT | |
| 13 | 20012-1 | 4 | J-BOLT, BATTERY HOLD DOWN, 1/4"-20 | |
| 14 | 80129 | 4 | WASHER, FENDER, 1/4"-20 | |
| 15 | 20012-4 | 4 | WASHER, GRAY PLASTIC, .25" X 1.25" X .88" | |
| 16 | 20012-3 | 4 | NUT, LOCK NYLON, 1/4"-20 | |
| 17 | 20077 | 4 | COUPLING, EYE, 1/4"-20 | |
| 18 | 85089 | 8 | WASHER, HARDENED, 1/4" | |
| 19 | 82359 | 4 | BOLT, HEX, 1/4"-20 X 3/4" | |
| 20 | 12070 | 1 | BRACKET, BATTERY STOP | |
| 21 | 82371 | 1 | BOLT, HEX, 5/16"-18 X 1" LONG | |
| 22 | 85090 | 2 | WASHER, HARDENED, 5/16" | |
| 23 | 85024 | 1 | NUT, LOCK NYLON, 5/16"-18 | |
| | 91250 | 1 | ASSEMBLY, BACK UP ALARM, STANDARD, VELVAC | |
| 24 | 40198 | 1 | BACKUP ALARM, STANDARD, VELVAC | |
| 25 | 82359 | 2 | BOLT, HEX, 1/4" X 1" LONG | |
| 26 | 85089 | 4 | WASHER, HARDENED, 1/4" | |
| 27 | 85023 | 2 | NUT, LOCK NYLON, 1/4"-20 | |
| REV | DATE | BY | | SHEET |
| C | 2/12/2016 | DFM | | 1 OF 3 |

TICO MANUFACTURING - RIDGELAND, SC 29936

| TICO PRO-SPOTTER | | | | |
|--|-----------|---|--|--------|
| S/N: | | BATTERY & WIRING - QSB3 IVi, ACC, 3 BATTERIES | | 720799 |
| ITEM | PART # | QTY/M | DESCRIPTION | TASK |
| 28 | 90207 | 1 | HORN, ELECTRIC | |
| 29 | 82359 | 1 | BOLT, HEX 1/4"-20 X 3/4" | |
| 30 | 85089 | 2 | WASHER, HARDENED, 1/4" | |
| 31 | 85023 | 2 | NUT, LOCK, NYLON, 1/4"-20 | |
| 32 | 62411 | 1 | HARNESS, CHASSIS, PDC TIER 4i QSB | |
| 33 | 61597 | 1 | SPACER | |
| 34 | 91938 | 1 | COVER, PDC PANEL | |
| 35 | 85089 | 2 | WASHER, HARDENED, 1/4" | |
| 36 | 85023 | 2 | NUT HEX, LOCK NYLON, 1/4"-20 | |
| 37 | 62265 | 1 | BRACKET, C, FRAME WIRING STANDOFF | |
| 38 | 90843 | 1 | CABLE, 3/0 RED BATTERY JUMPER, 9 1/2 HTH | |
| 39 | 90844 | 1 | CABLE, 3/0 BLACK BATTERY JUMPER, 9 1/2 HTH | |
| NOT SHOWN | 91223 | 1 | CABLE, 3/0 RED, BATTERY TO STARTER, 46" | |
| NOT SHOWN | 91224 | 1 | CABLE, 3/0 BLACK, BATTERY TO STARTER, 56" | |
| NOT SHOWN | 91518 | 1 | CABLE, 2/0 RED, BATTERY TO PDC, 34" | |
| NOT SHOWN | 91517 | 1 | CABLE, 2/0 BLACK, BATTERY TO PDC, 43" | |
| NOT SHOWN | 90877 | 1 | CABLE, 1/0 RED, LIFT PUMP TO PDC, 52 WIRE | |
| NOT SHOWN | 91229 | 4 | COVER, BATTERY POST (RED) | |
| NOT SHOWN | 91230 | 4 | COVER, BATTERY POST (BLACK) | |
| NOT SHOWN | 62415 | 1 | HARNESS, EXTERIOR LIGHTS, SEALED POWER CONNECTORS | |
| NOT SHOWN | 62167 | 1 | HARNESS, BACKUP ALARM | |
| NOT SHOWN | 61535 | 1 | HARNESS, WIRE, TAIL LIGHTS, 116" WHEEL BASE | |
| NOT SHOWN | 91171 | 1 | HARNESS, WIRE, AIR INTAKE, HEATER TO PDC, QSB4 & ISB13 | |
| NOT SHOWN | 62344 | 1 | HARNESS, WIRE, CAB PDC, QSB-IVi, ACC | |
| NOT SHOWN | 61558 | 1 | HARNESS, WIRE, CAB POWER | |
| NOT SHOWN | 61521 | 1 | HARNESS, WIRE, CAB ACC, (1 FANS/DOME LGT) | |
| NOT SHOWN | 91796 | REF | HARNESS, WIRE, CHASSIS EXTERIOR LIGHTS, CAB BAR, SEALED LIGHTS | |
| NOT SHOWN | 61559 | 1 | HARNESS, WIRE, SPITTER | |
| NOT SHOWN | 91132 | 1 | HARNESS, WIRE, CAB GROUND | |
| NOT SHOWN | 910327 | 1 | HARNESS, WIRE, CHASSIS PDC TO FRAME | |
| NOT SHOWN | 40801 | 1 | WIRE, 6GA, CAB TILT PUMP TO SWITCH | |
| NOT SHOWN | 91268 | 4 | SHRINK TUBING, 2" INSIDE DIAMETER, 6" LONG | |
| NOT SHOWN | 91154 | 1 | FLASHER, HEAVY DUTY | |
| REV | DATE | BY | | SHEET |
| C | 2/12/2016 | DFM | | 2 OF 3 |
| TICO MANUFACTURING - RIDGELAND, SC 29936 | | | | |

