

DIMENSIONS ARE IN INCHES		NAME	DATE	 WCO MANUFACTURING 44 CYPRESS RIDGE DR. ROCKLEIGH, NC 27088 (843) 717-2226
DRAWN	MAL	10/9/2017		
CHECKED				TITLE: COVERS & GRATINGS SIZE: DWG. NO. 71752-E1 REV D
APPROVED				
UNITS: 1: N/A 2: N/A 3: N/A 4: N/A 5: N/A 6: N/A 7: N/A 8: N/A 9: N/A 10: N/A		THE SUBJECT MATTER SHOWN AND DESCRIBED IN THE DRAWING AND ANY OTHER INFORMATION CONTAINED HEREIN IS THE PROPERTY OF WCO AND IS TO BE USED ONLY FOR THE PURPOSES SPECIFIED HEREIN. ALL RIGHTS TO ANY PATENTS, TRADEMARKS, OR OTHER INTELLECTUAL PROPERTY ARE RESERVED TO WCO.		SCALE: 1:32 WEIGHT: 457341 1 OF 2

D 71752-E1

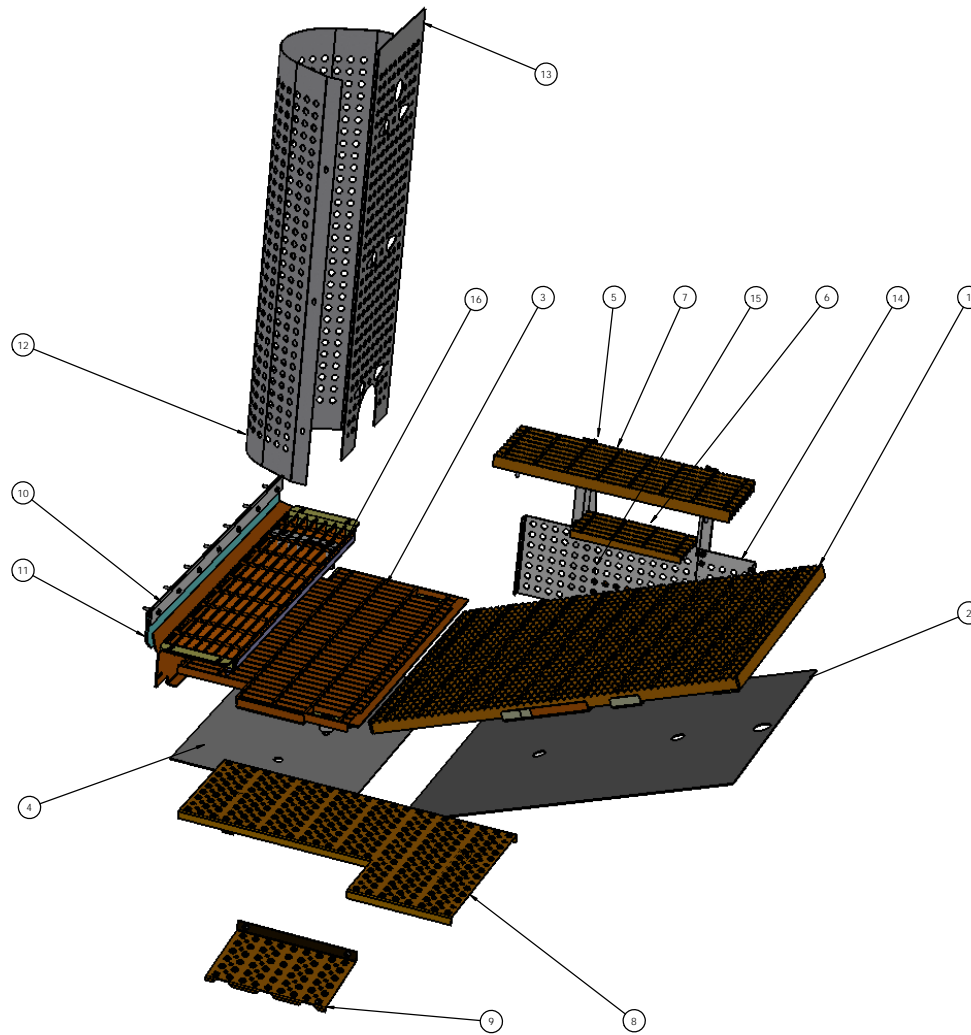

REFERENCES ARE IN INCHES	SCALE	DATE	TICCI TERMINAL SERVICE
DESIGNER: [blank]	SCALE: 1/32	DATE: 10/16/2017	44 CYPRUS BROOK DR. ROCKLAND, NC 27854 (843) 717-2226
BY: [blank]	CHECKED: [blank]	APPROVED: [blank]	TITLE: COVERS & GRATINGS
DATE: [blank]	PROJECT SCALE DRAWING	THE SUBJECT MATTER SHOWN AND DESCRIBED IN THE DRAWING AND ANY OTHER INFORMATION CONTAINED HEREIN IS FOR INFORMATION ONLY AND DOES NOT CONSTITUTE AN OFFER OF ANY SERVICE OR PRODUCT AND IS NOT TO BE USED FOR ANY PURPOSES WITHOUT THE WRITTEN CONSENT OF TICCI TERMINAL SERVICE, INC.	SIZE: [blank] DWG. NO: 71752-E1 REV: [blank]
SEE NOTE	SCALE: 1/32	WEIGHT: 457341	SHEET 2 OF 2
REVISIONS	DATE	DESCRIPTION	
[blank]	[blank]	[blank]	[blank]

D 71752-E1

TICO PRO-SPOTTER				
COVERS & GRATINGS, ISB W/STP, 65G TANK				71752
ITEM	PART #	QTY/M	DESCRIPTION	
	71752-E1	REF	COVERS AND GRATINGS, ISB	
1	30232	1	WELDMENT, BOOM COVER	
2	30233	1	HEAT SHIELD - BOOM COVER	
NOT SHOWN	82383	2	BOLT, HEX 3/8-16 x 1 1/4" LG	
NOT SHOWN	85113	2	WASHER, FLAT 3/8-16	
3	50230	1	GRATING, TRANSMISSION COVER, ISB-10, 72" CAB BAR	
4	50231	1	HEAT SHIELD - TRANS COVER	
NOT SHOWN	82383	3	BOLT, HEX 3/8-16 x 1 1/4" LG	
NOT SHOWN	85113	3	WASHER, FLAT 3/8-16	
NOT SHOWN	80205	3	NUT, FLANGE 3/8-16	
NOT SHOWN	50162-9	1	WASHER, FLAT - REAR MOUNT	
5	20083-8	1	WELDMENT, STEP BATTERY BOX	
NOT SHOWN	82372	4	BOLT, HEX 3/8-16 x 1" LG	
NOT SHOWN	85113	4	WASHER, FLAT 3/8-16	
NOT SHOWN	80205	4	NUT, FLANGE 3/8-16	
6	20083-4	1	WELDMENT, STEP MIDDLE BATTERY BOX	
7	20142	1	WELDMENT, STEP TOP BATTERY BOX-PT FRAME	
NOT SHOWN	82383	8	BOLT, HEX 3/8-16 x 1" LG	
NOT SHOWN	85091	8	WASHER, FLAT 3/8-16	
NOT SHOWN	80205	8	NUT, FLANGE 3/8-16	
8	20176	1	TREAD PLATE, TOP FUEL TANK	
NOT SHOWN	80378	10	CAPSCREW, 3/8-16 UNC X 1/2 LG BUTTONHEAD, SS	
NOT SHOWN	85091	10	WASHER, FLAT 3/8	
NOT SHOWN	85135	10	LOCKWASHER 3/8	
9	20062-2	1	INSERT, STEP BOTTOM FUEL TANK	
NOT SHOWN	80378	4	CAPSCREW, 3/8-16 UNC X 1/2 LG BUTTONHEAD, SS	
NOT SHOWN	85091	4	WASHER, FLAT 3/8-16	
NOT SHOWN	85135	4	LOCKWASHER 3/8	
10	90885-1	1	CLAMP PLATE	
11	90885-3	1	BAFFLE	
NOT SHOWN	82403	7	BOLT, HEX 1/4-20 x 1 3/4 Lg RUBBER to FLOOR	
NOT SHOWN	85089	14	WASHER, FLAT 1/4	
NOT SHOWN	85023	7	NUT, NYLOK 1/4-20	
REV	DATE	BY		SHEET
E	10/6/2017	MAL		1 OF 2

