

DETAIL A

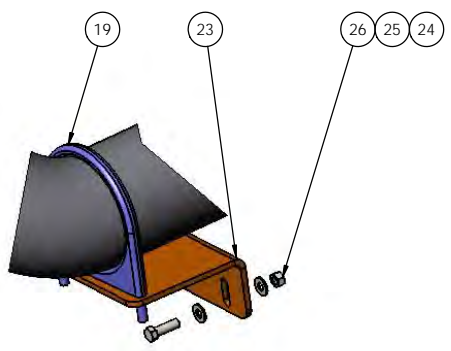

DETAIL B

DIMENSIONS ARE IN INCHES		NAME	DATE	 TICO MANUFACTURING 66 CYPRESS RIDGE DR. RIDGELAND, SC 29936 (843) 717-2226
TOLERANCES:		DRAWN	MAL	
DECIMAL:		CHECKED		
XXX ± 0.06		APPROVED		
XXX ± 0.03		DO NOT SCALE DRAWING		
XXXX ± 0.005		THE SUBJECT MATTER SHOWN AND DESCRIBED IN THIS DRAWING AND ANY OTHER INFORMATION ADVANCED IN CONNECTION THEREWITH IS PROPRIETARY PROPERTY AND IS TO BE HELD IN STRICT CONFIDENCE BY YOU. ALL RIGHTS TO ANY INVENTIONS, DESIGNS, TRADE MARKS, TRADE NAMES AND COPYRIGHTS DECLARED ARE RESERVED TO TICO TERMINAL SERVICES, INC.		
ANGULAR: ± 0.5°		MATERIAL		
FRACTIONAL: ± 1/32"		FINISH		
		THICKNESS		
		TITLE: AIR INTAKE SYSTEM QSB3 HMRO SIZE: C DWG. NO. 71288A SCALE: 1:24 WEIGHT: 82.38 SHEET 1 OF 1		REV

TICO PRO-SPOTTER

AIR INTAKE SYSTEM, ISB-10

71288

ITEM	PART #	QTY/M	DESCRIPTION	
	71288-C1	REF	ASSEMBLY, AIR INTAKE SYSTEM	
1	61665	1	FILTER- AIR, 11" DIA	
	61666	REF	FILTER ELMENT	
2	12014	1	BRACKET-AIR FILTER MOUNT	
3	12014-1	1	BRACKET-AIR FILTER MOUNT	
4	85561	2	BOLT, 1/2-NC X 5 1/4" LG HEX HD	
5	85093	2	WASHER-1/2	
6	85027	2	NUT-1/2 NC	
7	82371	5	BOLT, 5/16-NC X 1" LG HEX HD	
8	85090	10	WASHER-5/16	
9	85024	5	NUT-5/16 NC	
11	61642	1	ELBOW-5 X 6	
12	40674	1	TUBE-AIR INTAKE, 6"	
13	40673	1	SCREEN-AIR FILTER,6"	
14	40675	3	CLAMP, WORM GEAR SS 6" - 7.5 ID	
15	61754	1	TUBE-AIR INTAKE	
16	40760	2	HOSE-HUMP	
17	40190-1	4	CLAMP-CONSTANT TORQUE 6"	
18	61755	1	TUBE-ELBOW	
19	40683	1	CLAMP-SADDLE 5"	
20	90CB40L	1	ELBOW-CORBA	
21	40190-1	2	CLAMP-CONSTANT TORQUE 6"	
22	90953	1	HARNES AIR INTAKE RESTRICTION, 7'-CUMMINS	
23	12216	1	MOUNT BRACKET-INTAKE TUBE	
24	82394	2	BOLT, HEX 3/8-16 X 1 1/2" LG	
25	85036	2	LOCKNUT, 3/8-16	
26	85113	4	WASHER, FLAT 3/8	
27	40627	1	AIR FILTER MINDERGAGE	
28	60487-2	1	COUPLING	
29	40813	1	REDUCER	
REV	DATE	BY		SHEET
C	6/29/2017	MAL		1 OF 1

TICO MANUFACTURING - RIDGELAND, SC 29936