

DETAIL H
SCALE 1 : 3

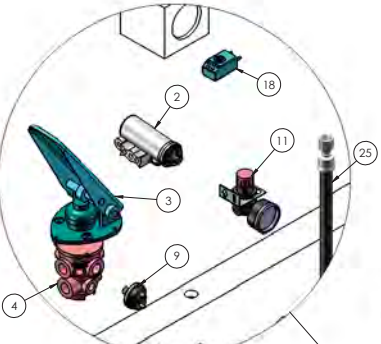

DETAIL I
SCALE 1 : 4

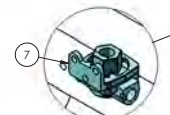

DETAIL A
SCALE 1 : 3

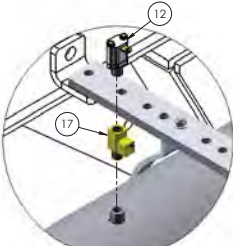

DETAIL G
SCALE 1 : 3

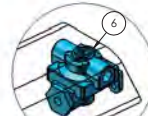

DETAIL F
SCALE 1 : 3

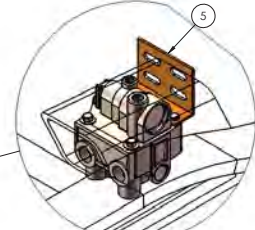

DETAIL E
SCALE 1 : 3

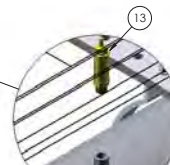

DETAIL D
SCALE 1 : 3



DETAIL C
SCALE 1 : 3

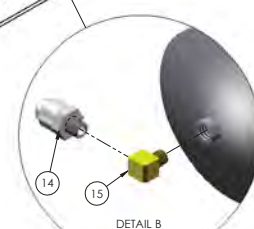

DETAIL B
SCALE 1 : 3

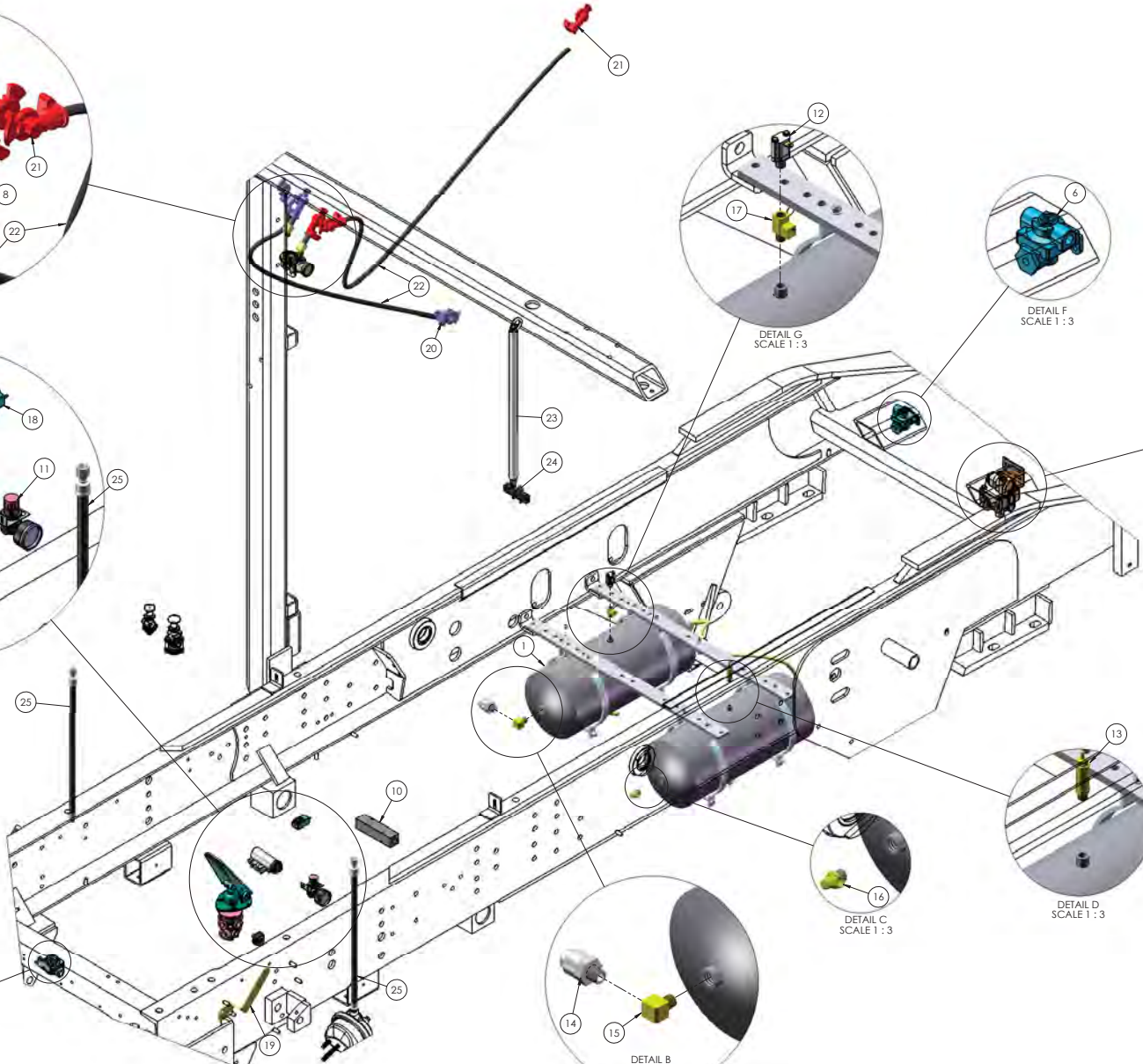

UNITS: DIMENSIONS ARE IN INCHES	DATE	5/7/15	SCALE: 1:3
DESIGNER: SWS	DATE	5/7/15	SCALE: 1:3
CHECKED:	DATE:		
APPROVED:	DATE:		
PROJECT: AIR SYSTEM	PROJECT NO:	71236-R1	REV: 1
ISSUES:	ISSUE NO:		
REVISIONS:	REVISION NO:		
DATE:	DATE:		
BY:	BY:		
FOR:	FOR:		
SCALE: 1:3	WEIGHT: 3541.33	SHEET 1 OF 1	

D 71236-R1

TICO PRO-SPOTTER				71236
S/N: AIR SYSTEM - OFF ROAD				
ITEM	PART #	QTY/M	DESCRIPTION	TASK
	71236-R1	REF	AIR SYSTEM - 2 TANK	
	61697	REF	SCHEMATIC, STANDARD SYSTEM, 2 TANKS	
1	42087	1	ASSEMBLY, AIR TANK, TWO TANKS	
2	60023	1	GOVERNOR, D2 W/GASKET	
3	90026	1	BRAKE PEDAL	
4	90057	1	VALVE, BRAKE, E-3	
5	40572	1	VALVE, BOBTAIL/PROPORTIONING, BP-R1 W/BRACKET	
6	10592	1	VALVE, BRAKE QUICK RELEASE, QR-1C	
7	40550	1	VALVE, BRAKE QUICK RELEASE, QR-1	
8	90069	1	VALVE, TRACTOR PROTECTION	
9	90078	2	SWITCH, PRESSURE	
10	10949	1	MANIFOLD, ASSEMBLY AIR	
11	90295	1	VALVE, AIR REGULATOR	
12	40776	1	SWITCH, LOW AIR PRESSURE (70 PSI)	
13	40022	1	VALVE, AIR PRESSURE RELIEF	
14	40029-1	1	VALVE, CHECK	
15	40817	1	ELBOW, 90°, 1/2" NPTM X 1/2" NPTF	
16	42064	1	PUSH CONNECT, 90°, 1/2" NPTM X 1/2" TUBE	
17	40900	1	TEE, BRASS STREET, 1/4" NPT	
18	90873	1	BUZZER, LOW AIR WARNING (70 PSI)	
19	62253	1	BRACKET, HOSE GUIDE	
	90095	REF	VALVE, TRAILER BRAKE	
	90094	REF	VALVE, TRACTOR BRAKE	
20	50038-1	3	GLADHAND, BLUE	
21	50039-1	3	GLADHAND, RED	
22	50303	2	HOSE ASSEMBLY, TRAILER AIR, 3/8 X 15 FT	
23	10356	1	SPRING	
24	40080	1	CLAMP, TRAILER HOSE	
25	40687	2	HOSE ASSEMBLY, FRONT BRAKE CHAMBER	
26	40799	2	FITTING, CLOSE NIPPLE, BRASS, 1/2 NPT	
27	40899	2	FITTING, ELBOW, 45°, BRASS, 1/2 NPT	
			NOTE: SET AIR GOVERNOR AT 120 PSI	
REV	DATE	BY		SHEET
				1 OF 1
TICO MANUFACTURING - RIDGELAND, SC 29936				

REV.	DESCRIPTION	ECN	DATE	APPROVED
A	PRODUCTION RELEASE	1003	1/27/10	HW
B	REVISED AIR TANKS ROUTING	1020	5/18/11	HW
C	LOW AIR WARNING SWITCH MOUNTED TO CAB	1024X	3/26/15	

